

oluce
Milano dal 1945



collection



Fare luce non basta.
Disegnare uno spazio modellandone volumi e disegnandone le ombre, arricchire un interno con presenze eleganti e mai invadenti, accompagnare i momenti della vita avvolgendo con calore gli ambienti, le persone, gli oggetti. Oluce, fin dai suoi albori, immagina oggetti fuori dal tempo, che non inseguono le mode o le tendenze. Lampade concepite come elementi d'arredo, che affascinano quando sono accese e stupiscono quando sono spente. Se la sua fortunata storia è stata tracciata da giganti del

design italiano come Vico Magistretti, Joe Colombo, Tito Agnoli e Marco Zanuso, oggi non abbandona speciali collaborazioni con nomi di rilievo che firmano creazioni destinate a rimanere nella storia del design, come Nendo, Angelettiruzza, Francesco Rota, Victor Vasilev, Christophe Pillet. Accanto alle collezioni a catalogo Oluce ha sviluppato un importante progetto di Bespoke Tailoring, un servizio che consente di ideare e realizzare oggetti creati ad hoc su progetti specifici o di personalizzare le lampade a catalogo soddisfacendo le richieste della propria clientela.

Creating lighting solutions is not enough. We want to design a space by shaping its volumes and drawing its shadows, enriching an interior with elegant and never intrusive items, and accompany life moments by warmly enveloping environments, people, and objects. Since its beginnings, Oluce has imagined timeless objects that do not follow fashions or trends. These lamps conceived as furnishing elements, fascinate when switched on and amaze when switched off. In its history Oluce has partnered with Italian design giants such as Vico Magistretti, Joe Colombo

Tito Agnoli and Marco Zanuso.
This approach continues today with special partnerships with famous names whose creations are destined to remain in the history of design, such as Nendo, angelettiruzza, Francesco Rota, Victor Vasilev, Christophe Pillet.
Alongside the catalogue collections, Oluce has developed an important Bespoke Tailoring project. This is a service to design and create ad hoc project-based objects or customise catalogue lamps to meet customer requests.



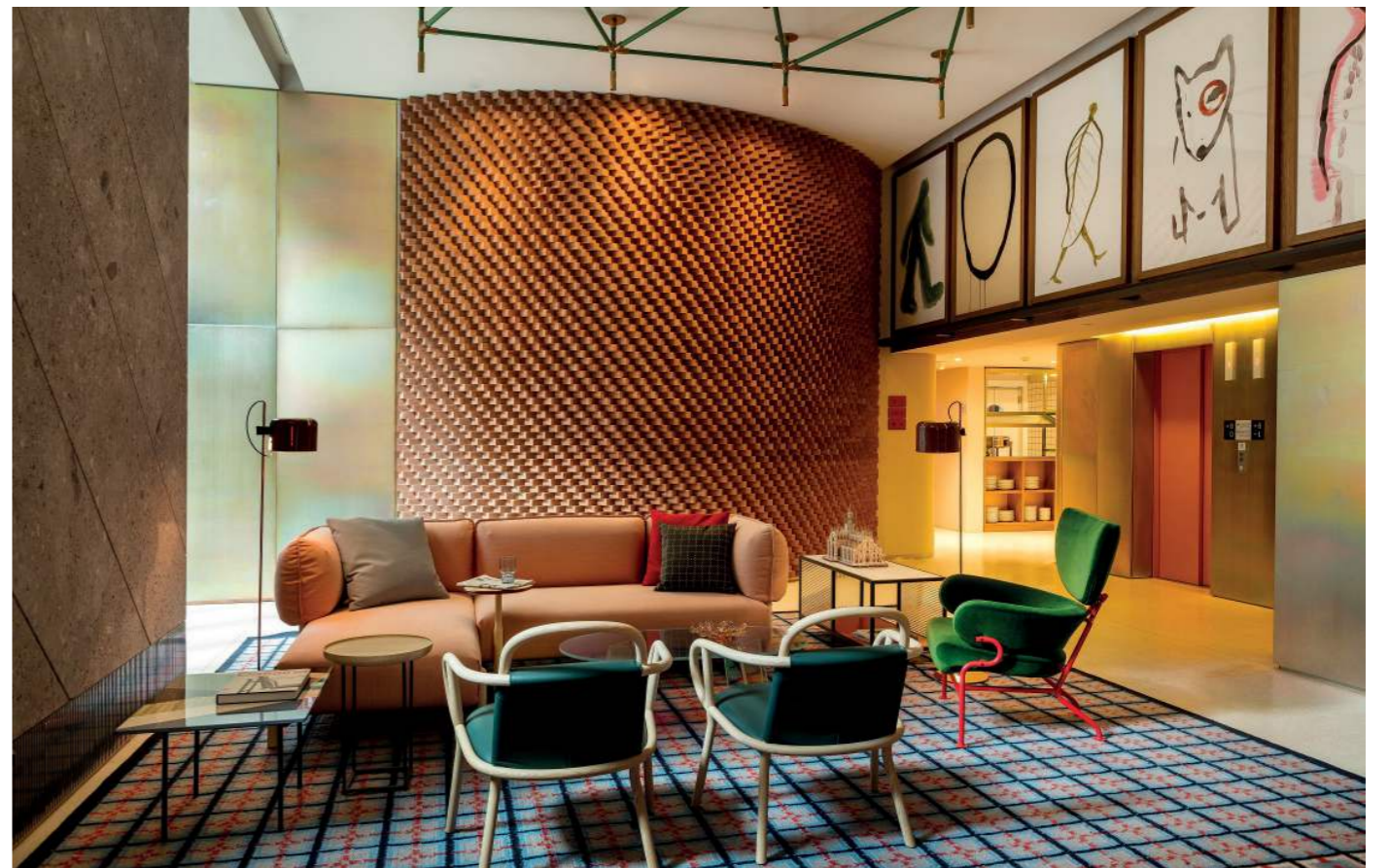
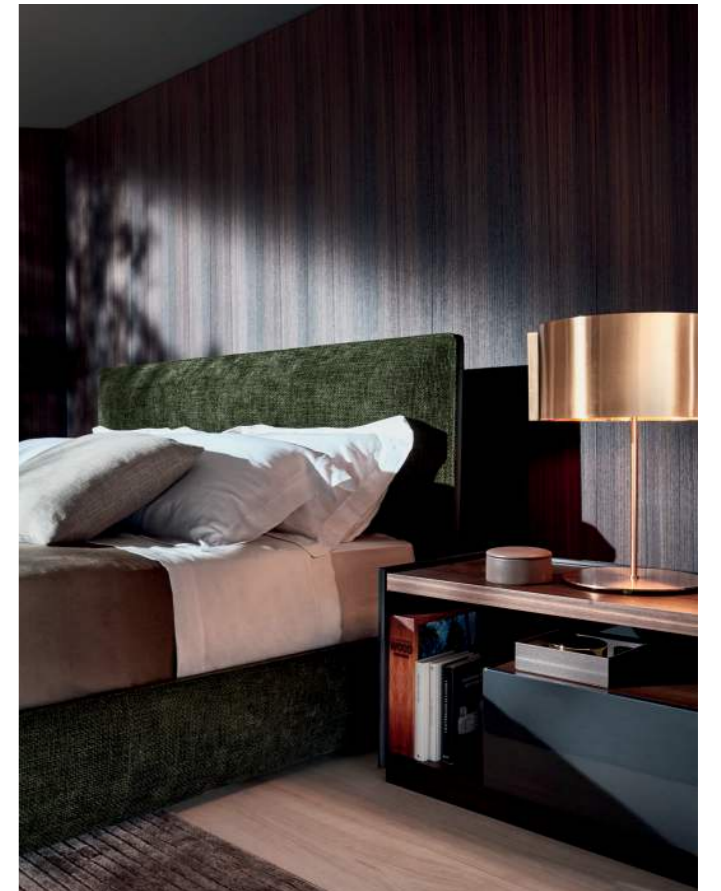







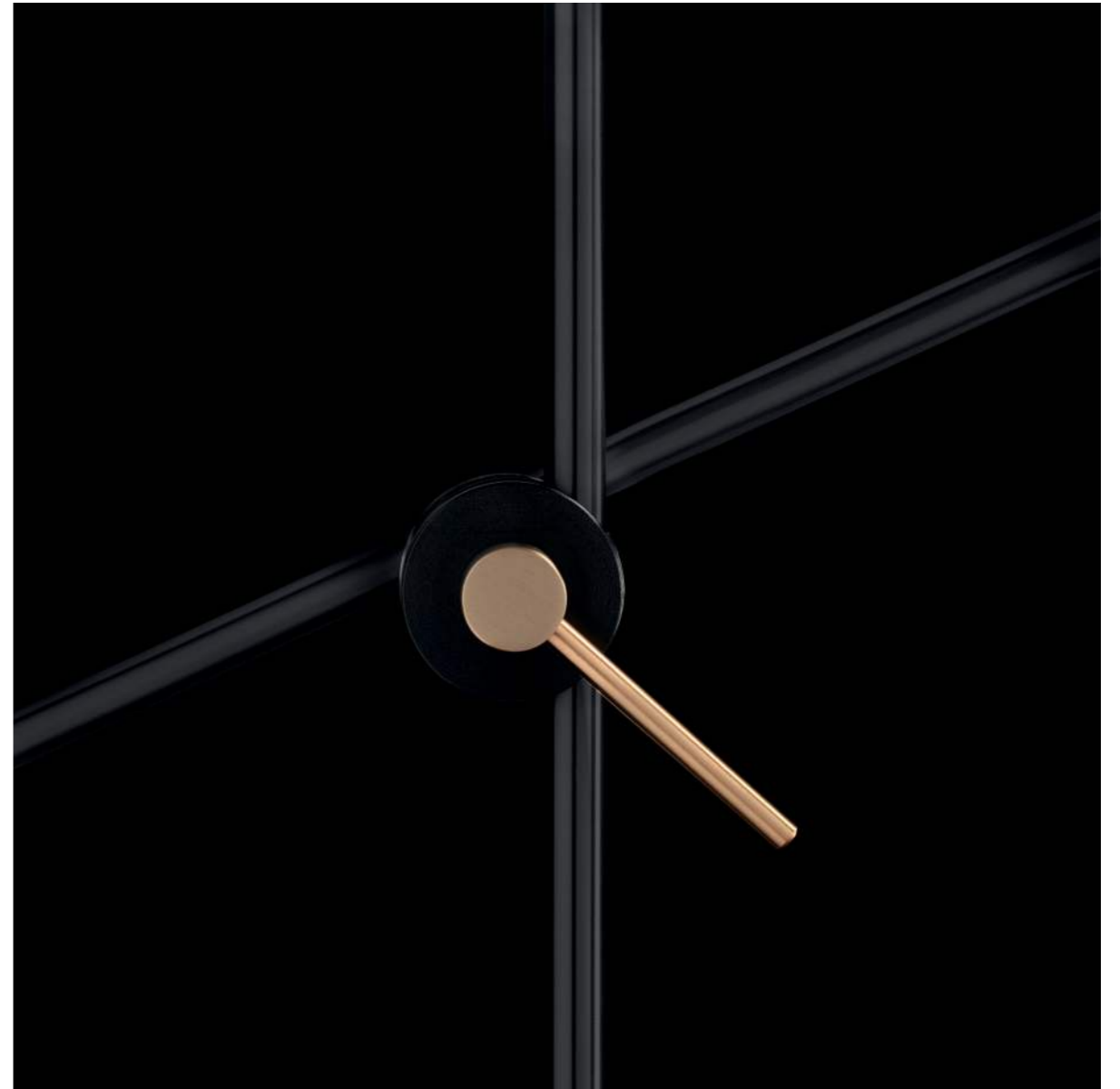

abaco / abacus

LAMPADE DA TAVOLO / TABLE LAMPS

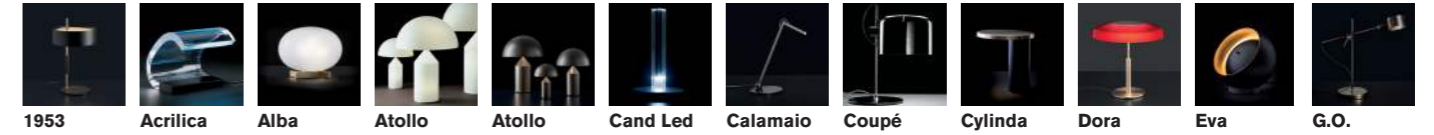

LAMPADE DA TERRA / FLOOR LAMPS



LAMPADE DA PARETE - SOFFITTO / WALL - CEILING LAMPS

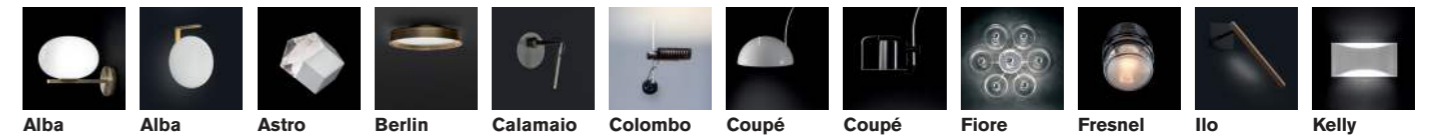

LAMPADE A SOSPENSIONE / SUSPENSION LAMPS



LAMPADE DA ESTERNO / OUTDOOR LAMPS

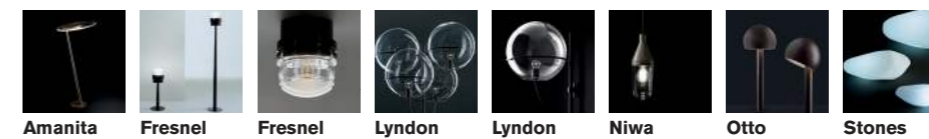

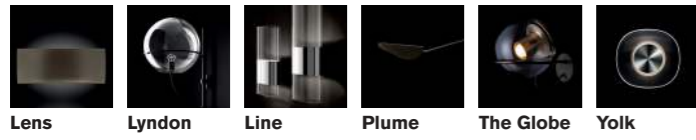
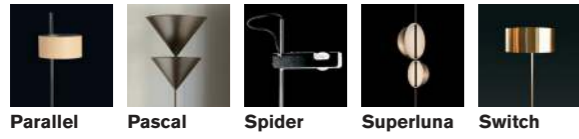

MINI COUPÈ

Joe Colombo
1967

lampade da tavolo / table lamps

22	MINI COUPÈ	60	ACRILICA
26	G.O.	64	CALAMAIO
28	ATOLLO	68	ALBA
40	DORA	70	SPIDER
42	SUPERLUNA	72	ZANUSO
44	1953	76	COUPÉ
46	THE GLOBE	78	SWITCH
48	PARALLEL	82	RECUERDO
50	SIRO	84	PLUME
54	MEDUSA	86	LU - LU
56	EVA	88	CAND - LED
58	CYLINDA		



2201

pagine/ pages

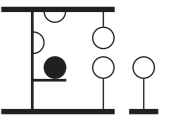
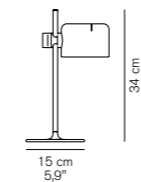

CODICE/CODE

2201



SORGENTI/BULBS

1 x max 5 W G9 (LED)

MATERIALI/MATERIALS

metallo/alluminio
metal/aluminium

COLORE/COLORS

nero lucido/lacquered black
bronzo anodico/anodic bronze
rosso scarlet/scarlet-red
giallo mustard/ mustard yellow

MARCHI/MARKS







G.O.
Giuseppe Ostuni
1961



252

pagine/pages

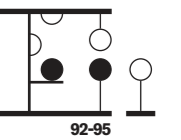
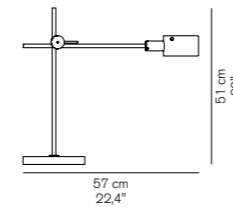

CODICE/CODE

SORGENTI/BULBS

MATERIALI/MATERIALS

COLORE/COLORS

MARCHI/MARKS

252



1 x max 10W - E14

metallo
metal

nero-bronzo anodic-rosso scarlet
black-anodic bronze-scarlet red





ATOLLO
Vico Magistretti
1977

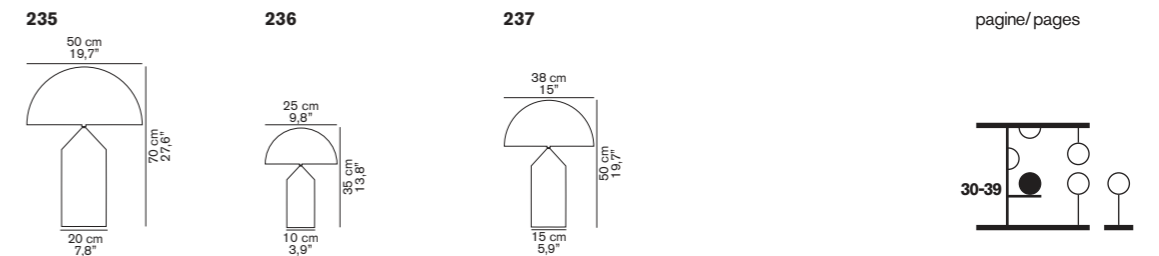

CODICE/CODE	SORGENTI/BULBS	MATERIALI/MATERIALS	COLORE/COLORS	MARCHI/MARKS
235 (universal dimmer)	2 x max 100 W – 2 x max 25 W E27 E14	metallo / vetro soffiato <i>metal / blown glass</i>	opale acidato <i>opaline opaque</i>	
236	2 x max 40 W – 1 x max 25 W E14	metallo / vetro soffiato <i>metal / blown glass</i>	opale acidato <i>opaline opaque</i>	
237 (universal dimmer)	2 x max 75 W – 1 x max 40 W E27 E14	metallo / vetro soffiato <i>metal / blown glass</i>	opale acidato <i>opaline opaque</i>	





ATOLLO
Vico Magistretti
1977

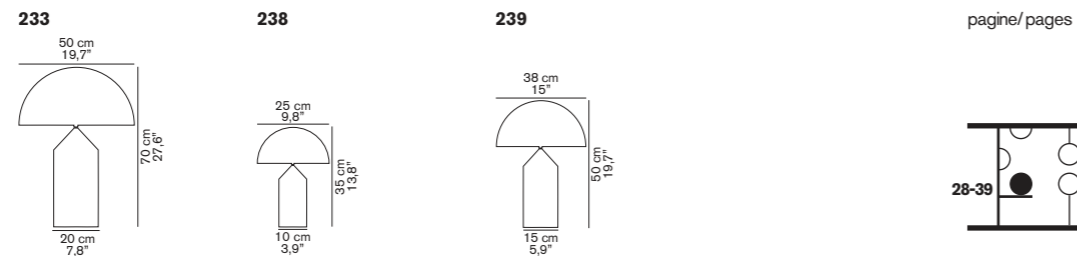

CODICE/CODE	SORGENTI/BULBS	MATERIALI/MATERIALS	COLORE/COLORS	MARCHI/MARKS
233 (universal dimmer)	2 x max 100 W E27	metallo metal	oro satinato satin gold	CE (U) CCC
238	2 x max 40 W E14	metallo metal	oro satinato satin gold	CE (U) CCC
239 (universal dimmer)	2 x max 75 W E27	metallo metal	oro satinato satin gold	CE (U) CCC

ATOLLO
Vico Magistretti
1977

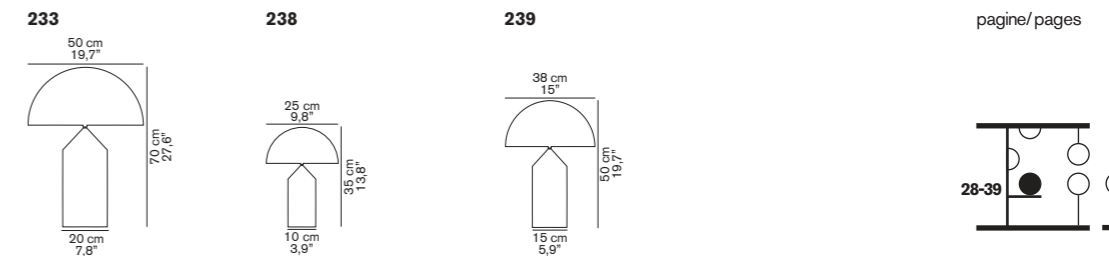

CODICE/CODE	SORGENTI/BULBS	MATERIALI/MATERIALS	COLORE/COLORS	MARCHI/MARKS
233 (universal dimmer)	2 x max 100 W E27	metallo metal	bianco/nero/bronzo satinato/ nickel nero satinato white/black/satin bronze/satin black nickel	CE (U) CCC
238	2 x max 40 W E14	metallo metal	nero/bronzo satinato/ nickel nero satinato black/satin bronze/satin black nickel	CE (U) CCC
239 (universal dimmer)	2 x max 75 W E27	metallo metal	nero/bronzo satinato / nickel nero satinato black/satin bronze/satin black nickel	CE (U) CCC







DORA
angelettiruzza design
2023



271

pagine/pages

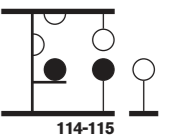
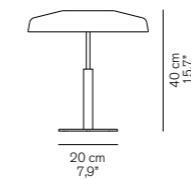

114-115

CODICE/CODE

SORGENTI/BULBS

MATERIALI/MATERIALS

COLORE/COLORS

MARCHI/MARKS

271
(dimmer)



1 x 9 W - LED - 2700°K - 1300
lm CRI>85

metallo/vetro
metal/glass

nickel nero satinato - vetro fumè /
oro satinato - vetro rosso sabbato
satin black nickel - smokey glass /
satin gold - sand-blasted red glass





SUPERLUNA

Victor Vasilev
2015



297

pagine/pages

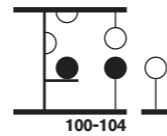
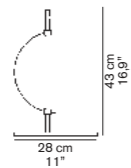

CODICE/CODE	SORGENTI/BULBS	MATERIALI/MATERIALS	COLORE/COLORS	MARCHI/MARKS
297	1 x max 7,5 W LED 24 V 3000°K 765 lm CRI >85	metallo <i>metal</i>	anodizzato ottone - asta nera / nero - asta nera <i>anodized brass - black stem / black - black stem</i>	CE UL ENEC



1953

Ostuni & Forti
1953



243

pagine/ pages

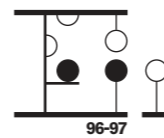
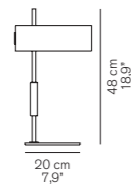

CODICE/CODE	SORGENTI/BULBS	MATERIALI/MATERIALS	COLORE/COLORS	MARCHI/MARKS
243 (universal dimmer)	1 x max 75W E27	metallo metal	nero opaco / oro satinato matt black / satin gold	CE UL

THE GLOBE

Joe Colombo
1964



228

pagine/ pages

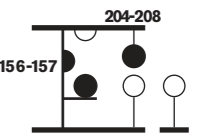
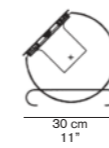

CODICE/CODE	SORGENTI/BULBS	MATERIALI/MATERIALS	COLORE/COLORS	MARCHI/MARKS
228	1 x max 60 W E27	metallo/ vetro soffiato metal/ blown glass	nickel satinato - oro satinato / bronzo anodico satin nickel - satin gold / anodic bronze	CE EEC



PARALLEL

Victor Vasilev
2022



296

pagine/pages

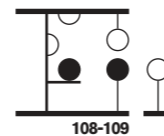
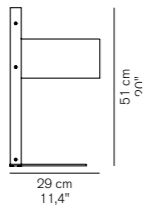

108-109

CODICE/CODE	SORGENTI/BULBS	MATERIALI/MATERIALS	COLORE/COLORS	MARCHI/MARKS
296 (universal dimmer)	1 x max 60 W E27	metallo / pelle metal / leather	cuoio-sabbia leather brown-sand	CE

SIRO

Marta Perla
2019



287

288

pagine/pages

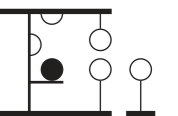
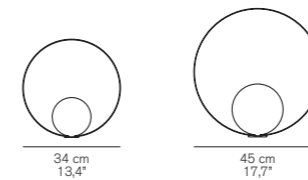

CODICE/CODE	SORGENTI/BULBS	MATERIALI/MATERIALS	COLORE/COLORS	MARCHI/MARKS
287 (dimmer)	1 x max 8,5W LED 2700° K 1330 lm CRI>90	metallo metal	bronzo satinato-oro satinato smaltato satin bronze - satin gold glaze	CE
288 (dimmer)	1 x max 13W LED 2700° K 1700 lm CRI>90	metallo metal	bronzo satinato-oro satinato smaltato satin bronze - satin gold glaze	CE





MEDUSA

Quaglio Simonelli,
2023



254

pagine/pages

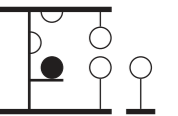
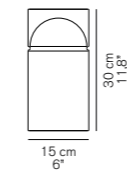

CODICE/CODE

SORGENTI/BULBS

MATERIALI/MATERIALS

COLORE/COLORS

MARCHI/MARKS

254



1 x 4 W - LED - 2700°K -
500 lm CRI>85

metallo / vetro pyrex
metal / pyrex glass

nero / oro satinato / rosso scarlet
black / satin gold / scarlet red





EVA
 Francesca Borelli
 2017



216

pagine/pages

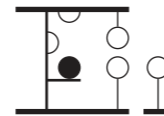
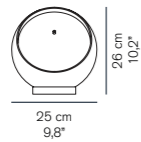

CODICE/CODE	SORGENTI/BULBS	MATERIALI/MATERIALS	COLORE/COLORS	MARCHI/MARKS
216	1 x max 12,5W LED 3000°K 1770 lm CRI>85	metallo metal	esterno nero / interno foglia oro black outside / gold leaf inside	CE ENEC

CYLINDA
 angelettiruzza design
 2017



218

pagine/pages

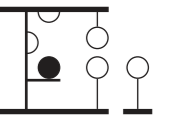
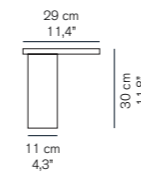

CODICE/CODE	SORGENTI/BULBS	MATERIALI/MATERIALS	COLORE/COLORS	MARCHI/MARKS
218	1 x max 12,5W LED 3000°K 1770 lm CRI>85	metallo metal	nero opaco / nero opaco - oro satinato nero opaco / matt black - satin gold	CE ENEC



ACRILICA

Gianni e Joe
Colombo
1962



281 LBT

pagine/pages

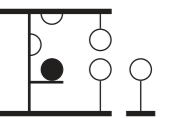
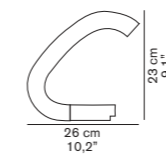

CODICE/CODE

SORGENTI/BULBS

MATERIALI/MATERIALS

COLORE/COLORS

MARCHI/MARKS

281 LBT



1 x max 4W (LED)
2700°K 570 lm CRI>85

metallo / PMMA
metal / PMMA

trasparente
transparent





ACRILICA

Gianni e Joe
Colombo
1962

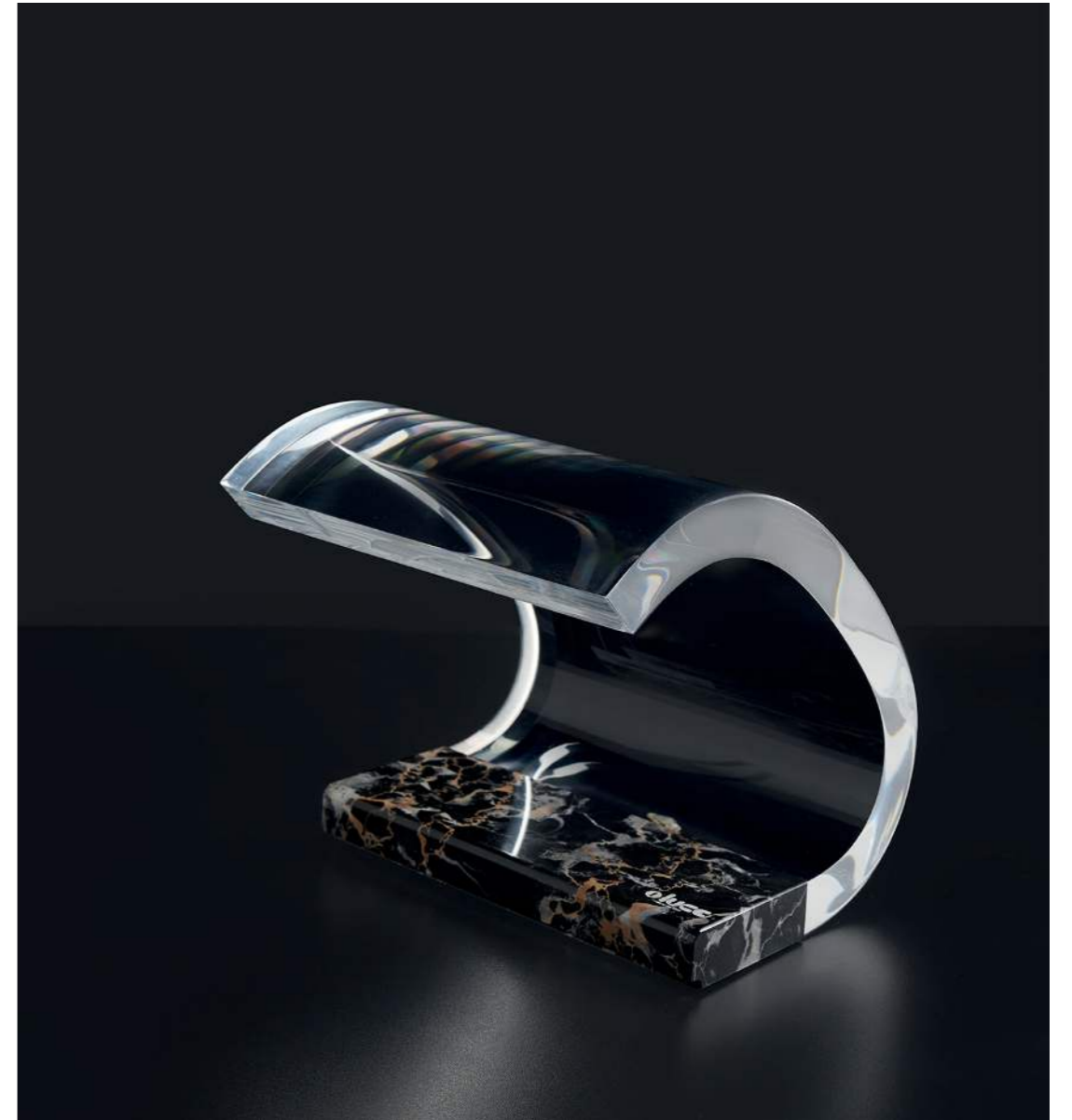

281 MP - LIMITED EDITION

pagine/pages

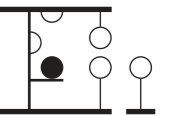
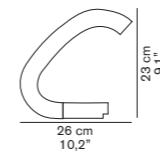

CODICE/CODE

281 MP

SORGENTI/BULBS

1 x max 4W (LED)
2700°K 570 lm CRI>85

MATERIALI/MATERIALS

marmo portoro / PMMA
portoro marble / PMMA

COLORE/COLORS

trasparente
transparent

MARCHI/MARKS

CE



CALAMAIO

Cervellieri, Di Lorenzo,
Montini
2023



298

pagine/ pages

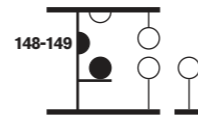
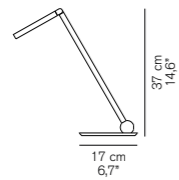

CODICE/CODE	SORGENTI/BULBS	MATERIALI/MATERIALS	COLORE/COLORS	MARCHI/MARKS
298	1 x 2 W - LED - 2700°K - 285 lm CRI>85	metal metal	nickel nero satinato / rosso scarlet / giallo mustard satin black nickel / scarlet red / mustard yellow	CE





ALBA
 Mariana
 Pellegrino Soto
 2017



265

pagine/ pages

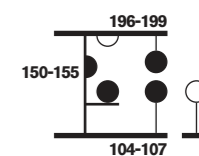
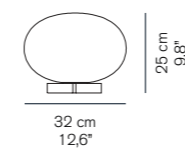

CODICE/CODE	SORGENTI/BULBS	MATERIALI/MATERIALS	COLORE/COLORS	MARCHI/MARKS
265 (universal dimmer)	1 x max 60 W E27	metallo /vetro soffiato metal /blown-glass	anodizzato ottone satinato /opale lucido anodized satin brass /polished opaline	CE



SPIDER
Joe Colombo
1965



291

pagine/ pages

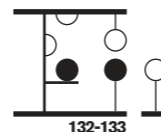
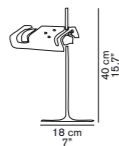

CODICE/CODE	SORGENTI/BULBS	MATERIALI/MATERIALS	COLORE/COLORS	MARCHI/MARKS
291	1 x max 48 W G9	metallo /alluminio metal /aluminium	nero /giallo mustard black /mustard yellow	CE EKO UL

ZANUSO
Marco Zanuso
1965



275

pagine/ pages

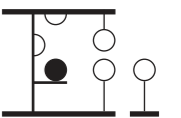
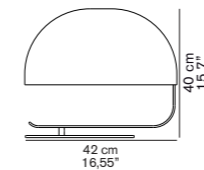

CODICE/CODE	SORGENTI/BULBS	MATERIALI/MATERIALS	COLORE/COLORS	MARCHI/MARKS
275	1 x max 70 W E27	metallo /PMMA metal /PMMA	bianco /castano white /nut brown	CE





COUPÉ
Joe Colombo
1967



2202

pagine/pages

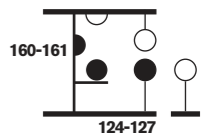
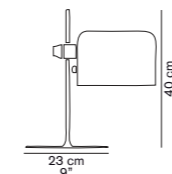

CODICE/CODE

SORGENTI/BULBS

MATERIALI/MATERIALS

COLORE/COLORS

MARCHI/MARKS

2202

☀
1 x max 100 W
💡 E27

metallo / alluminio
metal / aluminium

nero / rosso scarlet
black / scarlet red

CE UH ecc



SWITCH

Nendo
2007



206

pagine/ pages

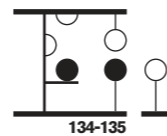
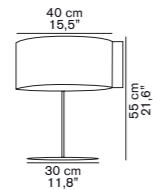

CODICE/CODE	SORGENTI/BULBS	MATERIALI/MATERIALS	COLORE/COLORS	MARCHI/MARKS
206	2 x max 100 W E27	metallo /metal metallo /metal	nero /oro satinato black /satin gold	CE



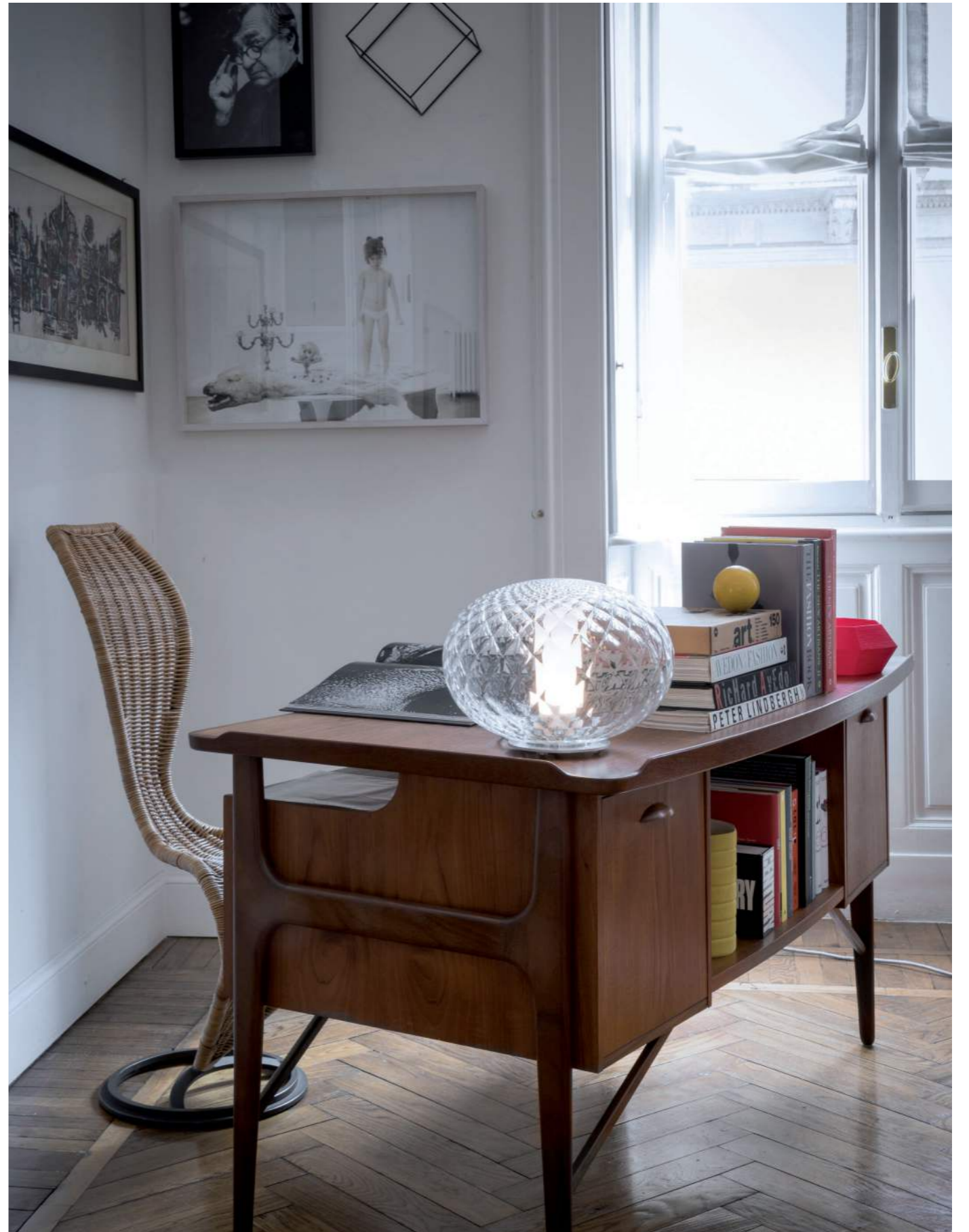

RECUERDO



Mariana
Pellegrino Soto
2017

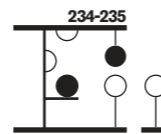
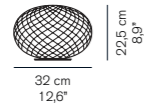

284

pagine/ pages



CODICE/CODE	SORGENTI/BULBS	MATERIALI/MATERIALS	COLORE/COLORS	MARCHI/MARKS
284	 1 x max 12 W 220V LED 3000°K 1130lm CRI>85	vetro soffiato /alluminio <i>blown-glass /aluminium</i>	trasparente /alluminio anodico <i>transparent /anodic aluminium</i>	

PLUME

Christophe Pillet
2017



221

pagine/ pages

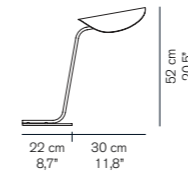

CODICE/CODE	SORGENTI/BULBS	MATERIALI/MATERIALS	COLORE/COLORS	MARCHI/MARKS
221	 1 x max 40W  E14	metallo <i>metal</i>	bronzo anodico <i>anodic bronze</i>	



LU-LU

Stefano Casciani
1996



211

pagine/ pages

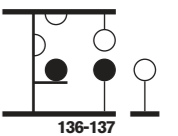
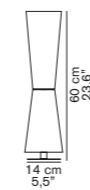

136-137

CODICE/CODE	SORGENTI/BULBS	MATERIALI/MATERIALS	COLORE/COLORS	MARCHI/MARKS
211 (universal dimmer)	 1 x max 100 W – 1 x max 60 W  E27	metallo / vetro soffiato metal / blown glass	opale acidato opaline opaque	 



CAND-LED

Laudani & Romanelli
2005



205

pagine/ pages

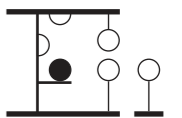
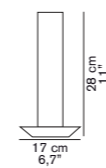

CODICE/CODE

SORGENTI/BULBS

MATERIALI/MATERIALS

COLORE/COLORS

MARCHI/MARKS

205



1 x max 1W
LED

alluminio /PMMA
aluminium /PMMA

trasparente
transparent





lampade da terra

/ floor lamps

- | | |
|----------------------|--------------------|
| 92 G.O. | 116 COLOMBO |
| 96 1953 | 120 AMANITA |
| 98 BERLIN | 122 PASCAL |
| 100 SUPERLUNA | 124 COUPÉ |
| 104 ALBA | 130 AGNOLI |
| 108 PARALLEL | 132 SPIDER |
| 110 LAS | 134 SWITCH |
| 114 DORA | 136 LU - LU |

G.O.
Giuseppe Ostuni
1961



352

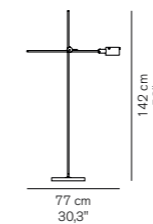

pagine/ pages

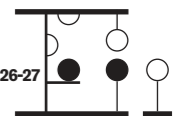

CODICE/CODE	SORGENTI/BULBS	MATERIALI/MATERIALS	COLORE/COLORS	MARCHI/MARKS
352	1 x max 10W - E14	metallo metal	nero-bronzo anodic-rosso scarlet black-anodic bronze-scarlet red	CE





1953
Ostuni & Forti
1953



343



pagine/pages

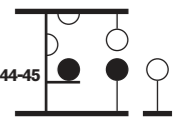

CODICE/CODE

343
(universal dimmer)



SORGENTI/BULBES

2 x max 75W
E27

MATERIALI/MATERIALS

metallo
metal

COLORE/COLORS

nero opaco/oro satinato
matt black/satin gold

MARCHI/MARKS



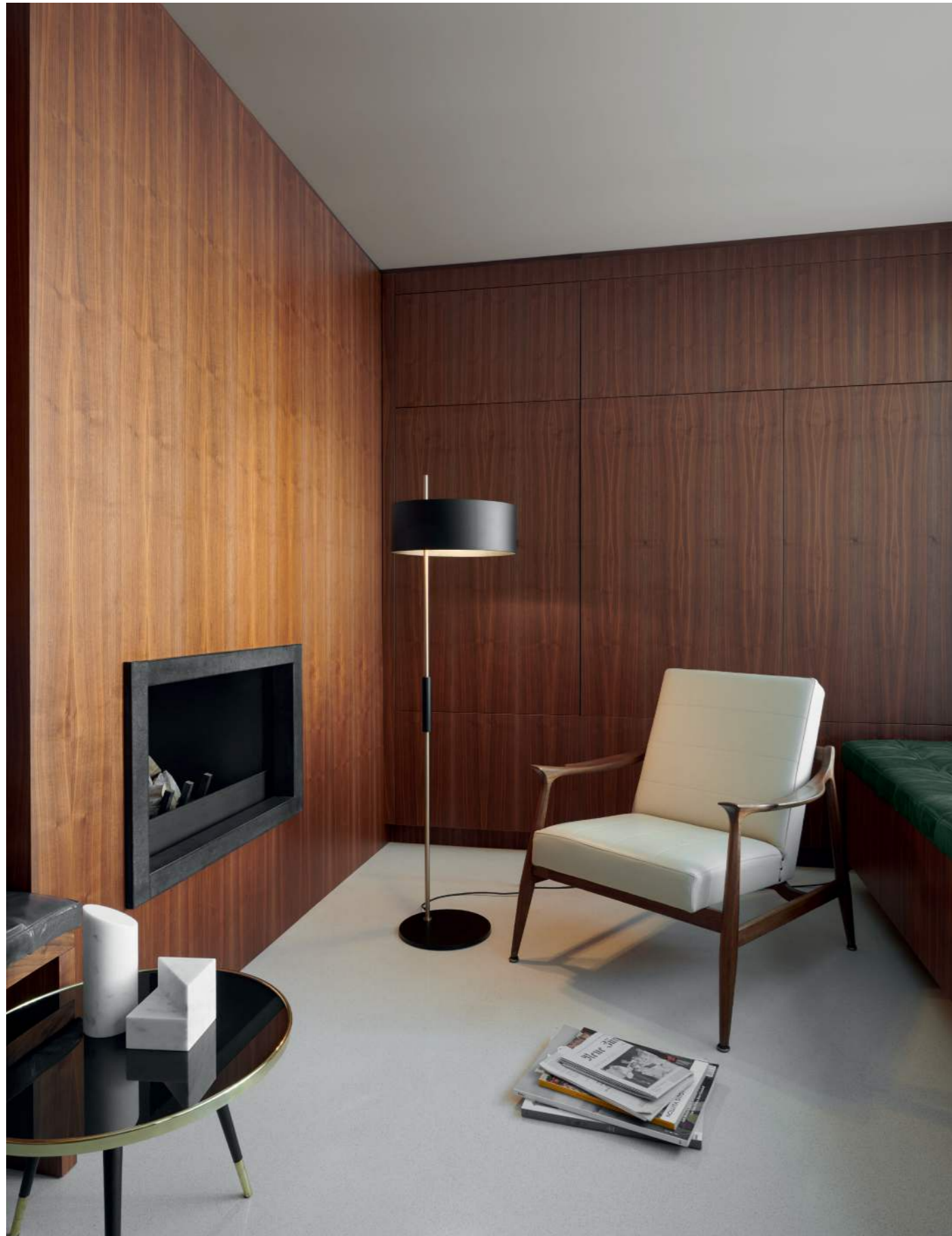

BERLIN

Christophe Pillet
2023



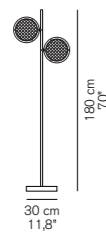

323

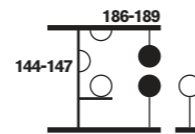

pagine/ pages



CODICE/CODE	SORGENTI/BULBS	MATERIALI/MATERIALS	COLORE/COLORS	MARCHI/MARKS
323 (dimmer)	 2 x 15 W - LED - 2700°K - 4300 lm CRI>85 	metallo/vetro retinato sabbaiato <i>metal/sand-blasted wired glass</i>	nero opaco/nero opaco - anodizzato ottone <i>matt black/matt black - anodized brass</i>	

SUPERLUNA

Victor Vasilev
2015



397



pagine/ pages

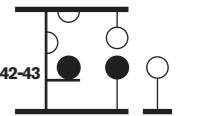

CODICE/CODE	SORGENTI/BULBS	MATERIALI/MATERIALS	COLORE/COLORS	MARCHI/MARKS
397	 2 x max 7,5 W LED 24 V 3000°K 1530lm CRI>85 	metallo <i>metal</i>	anodizzato ottone - asta nera / nero - asta nera <i>anodized brass - black stem / black - black stem</i>	  





ALBA

Mariana
Pellegrino Soto
2017



382

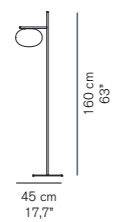

383

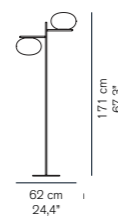

pagine/pages

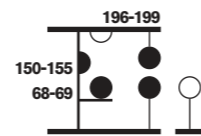

CODICE/CODE	SORGENTI/BULBS	MATERIALI/MATERIALS	COLORE/COLORS	MARCHI/MARKS
382 (universal dimmer)	1 x max 60 W E27	metallo/vetro soffiato metal/blown-glass	anodizzato ottone satinato - bronzo anodic anodized satin brass - anodic bronze	CE EEC
383 (universal dimmer)	2 x max 60 W E27	metallo/vetro soffiato metal/blown-glass	anodizzato ottone satinato - bronzo anodic anodized satin brass - anodic bronze	CE EEC





PARALLEL
Victor Vasilev
2022



396

pagine/pages

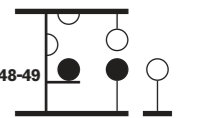
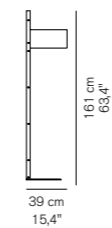

CODICE/CODE

SORGENTI/BULBS

MATERIALI/MATERIALS

COLORE/COLORS

MARCHI/MARKS

396
(universal dimmer)



2 x max 60 W
E27

metallo/pelle
metal/leather

cuoio - sabbia
leather brown - sand





LAS
Mist-o
2015

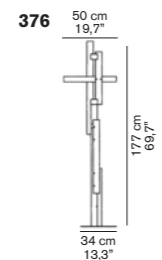

pagine/pages

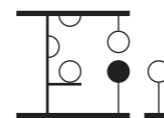

CODICE/CODE	SORGENTI/BULBS	MATERIALI/MATERIALS	COLORE/COLORS	MARCHI/MARKS
376	3 x max 18 W LED 3000°K 3x2300 lm CRI >85	metallo metal	nero opaco - nero /grigio matt black - black/grey	CE





DORA

angelettiruzza design
2023



371

pagine/ pages

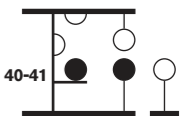
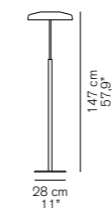

CODICE/CODE

SORGENTI/BULBS

MATERIALI/MATERIALS

COLORE/COLORS

MARCHI/MARKS

371
(dimmer)



1 x 13 W - LED - 2700°K -
1875 lm CRI>85

metallo / vetro
metal / glass

nickel nero satinato - vetro fumè /
oro satinato - vetro rosso sabbato
satin black nickel - smokey glass /
satin gold - sand-blasted red glass





COLOMBO

Joe Colombo
1970

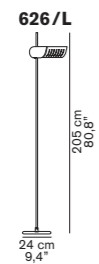
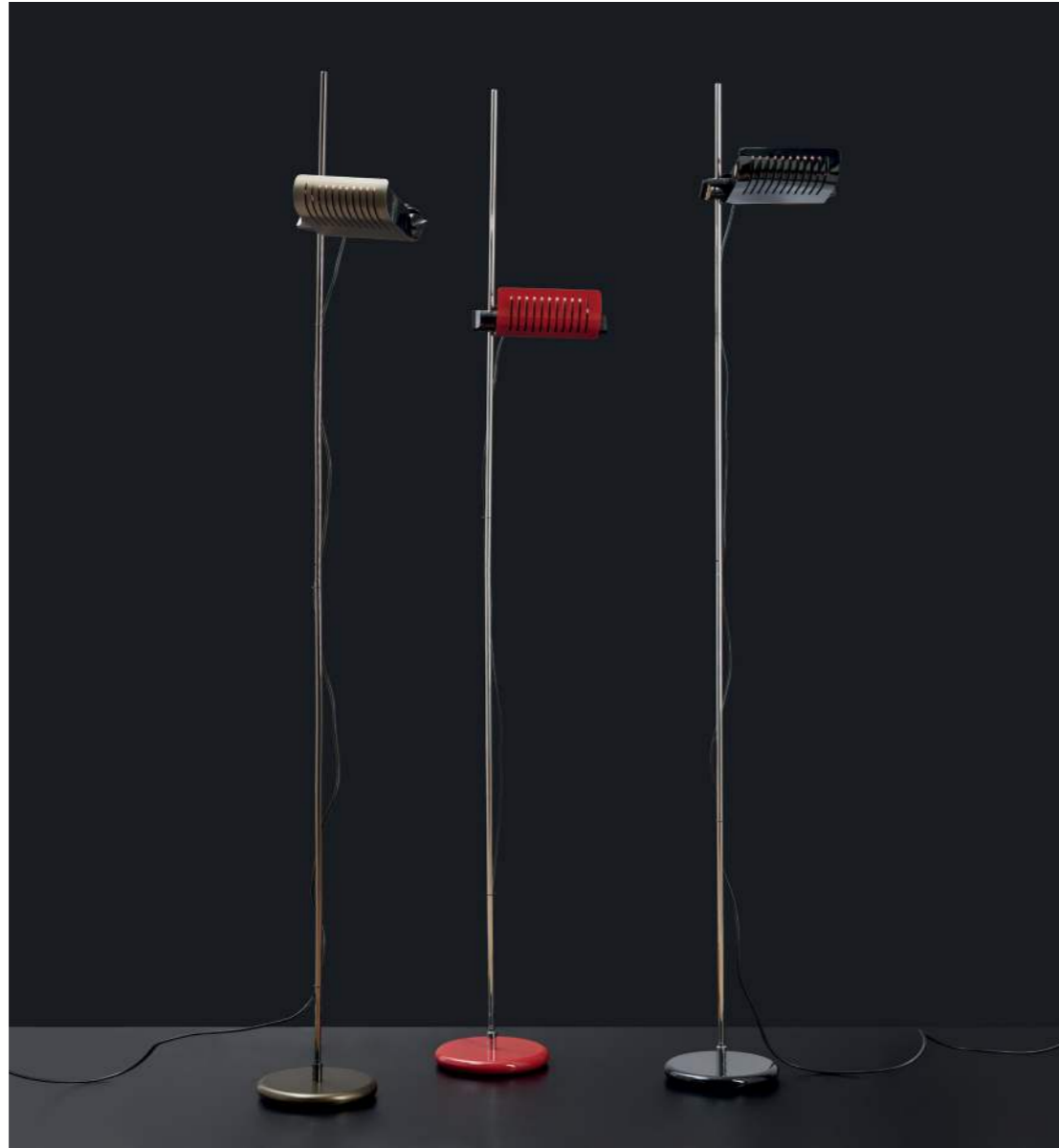

pagine/pages

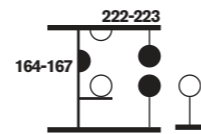

CODICE/CODE	SORGENTI/BULBS	MATERIALI/MATERIALS	COLORE/COLORS	MARCHI/MARKS
626/L (dimmer)	1 x max 24 W LED 2700°K 4100 lm CRI >85	metallo/alluminio metal/aluminium	nero asta cromo - bronzo anodic asta nera - rosso scarlet asta cromo black stem chrome - anodic bronze stem black - scarlet red stem chrome	CE





AMANITA
Mariana
Pellegrino Soto
2019



619

pagine/ pages

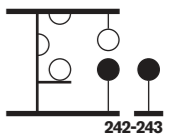

CODICE/CODE

SORGENTI/BULBES

MATERIALI/MATERIALS

COLORE/COLORS

MARCHI/MARKS

619
(dimmer)



1 x max 18W LED
2700° K 2600 lm CRI>85

metallo
metal

bronzo anodic / oro satinato
anodic bronze / satin gold





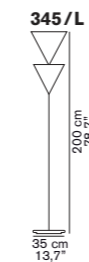

PASCAL
Vico Magistretti
1983

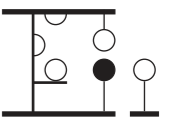

pagine/ pages



CODICE/CODE	SORGENTI/BULBS	MATERIALI/MATERIALS	COLORE/COLORS	MARCHI/MARKS
345 /L	 1 x max 24 W LED 2700°K 4100 lm CRI >85 + 2 x max 100 W E 27	metallo /alluminio metal /aluminium	bronzo anodico anodic bronze	



COUPÈ

Joe Colombo
1967



3321

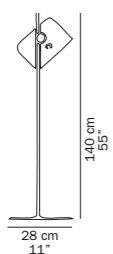

pagine/ pages



CODICE/CODE	SORGENTI/BULBS	MATERIALI/MATERIALS	COLORE/COLORS	MARCHI/MARKS
3321	1 x max 100 W E27	metallo /alluminio metal /aluminium	nero /rosso scarlet black /scarlet red	CE UL EEC





COUPÉ
Joe Colombo
1967



3320/R

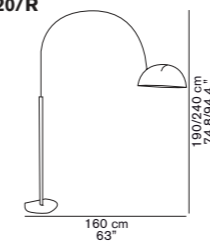

pagine/ pages

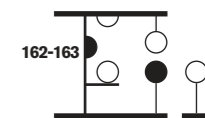

CODICE/CODE

SORGENTI/BULBS

MATERIALI/MATERIALS

COLORE/COLORS

MARCHI/MARKS

3320/R

☀
1 x max 100 W
💡 E27

metallo /alluminio
metal /aluminium

bianco /nero
white/black

CE



AGNOLITito Agnoli
1955

387



pagine/ pages

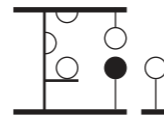

CODICE/CODE	SORGENTI/BULBS	MATERIALI/MATERIALS	COLORE/COLORS	MARCHI/MARKS
387	1 x max 48 W G9	metallo metal	nickel satinato satin nickel	CE

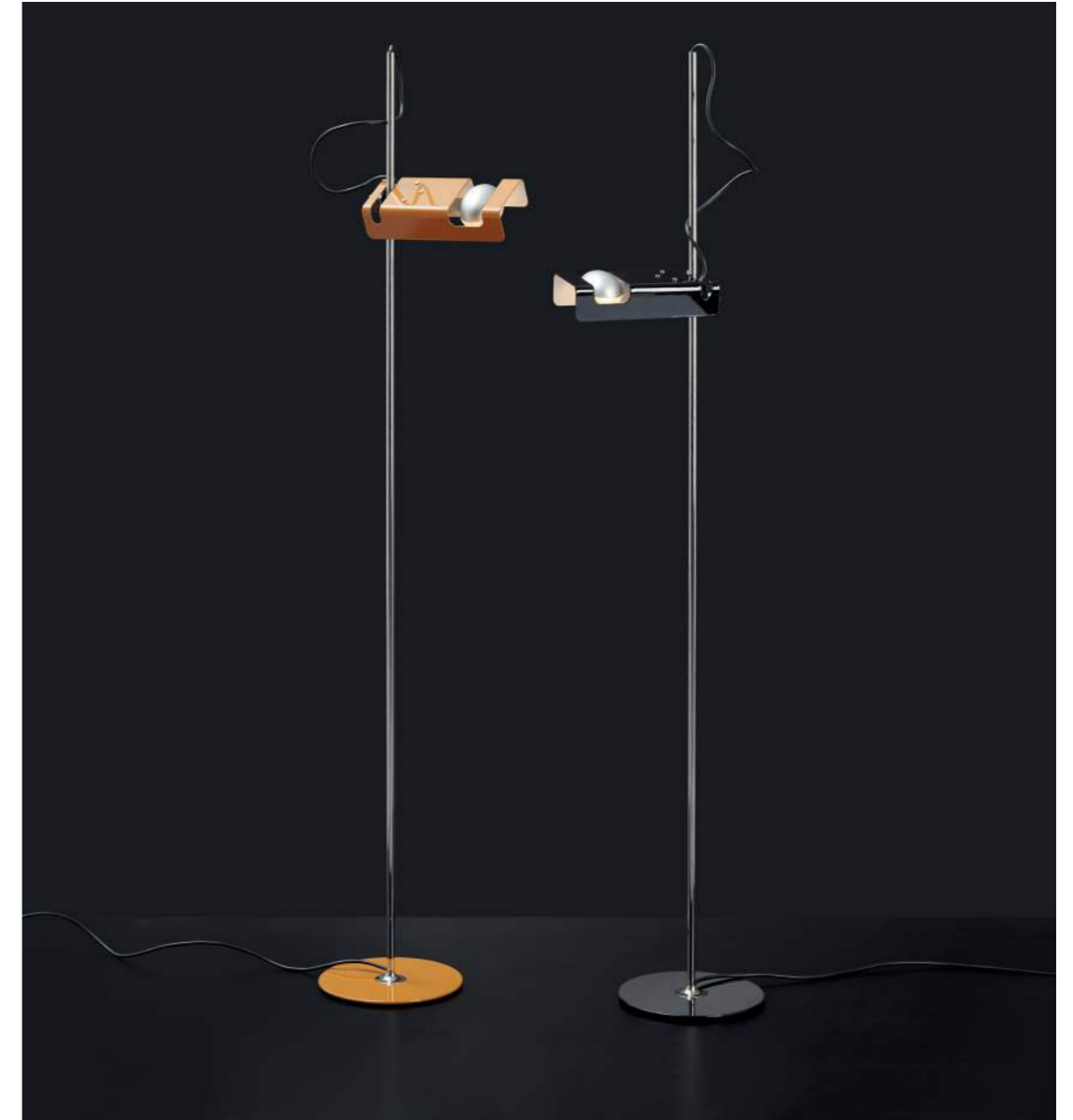
SPIDERJoe Colombo
1965

3319



pagine/ pages

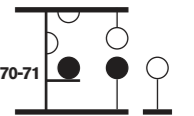

CODICE/CODE	SORGENTI/BULBS	MATERIALI/MATERIALS	COLORE/COLORS	MARCHI/MARKS
3319	1 x max 48 W G9	metallo/alluminio metal/aluminium	nero/giallo mustard black/mustard yellow	CE (E) UL



SWITCH

Nendo
2007



306

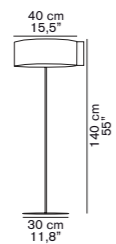

pagine/ pages

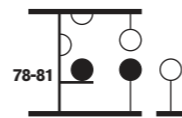

CODICE/CODE	SORGENTI/BULBS	MATERIALI/MATERIALS	COLORE/COLORS	MARCHI/MARKS
306	2 x max 100 W E27	metallo metal	nero /oro satinato black /satin gold	

LU-LU

Stefano Casciani
1996



311

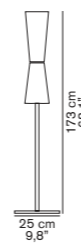

pagine/ pages

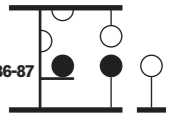

CODICE/CODE	SORGENTI/BULBS	MATERIALI/MATERIALS	COLORE/COLORS	MARCHI/MARKS
311 (universal dimmer)	1 x max 100 W – 1 x max 60 W E27	metallo /vetro soffiato metal /blown glass	opale acidato opaline opaque	



lampade da parete / wall lamps

140	ILO	168	FRESNEL
144	BERLIN	170	YOLK
148	CALAMAIO	172	KELLY
150	ALBA	174	LINE
156	THE GLOBE	176	LYNDON
158	LENS	178	FIORE
160	COUPÉ	180	PLUME
164	COLOMBO	182	ASTRO



ILO
David Lopez
Quincoces
2019

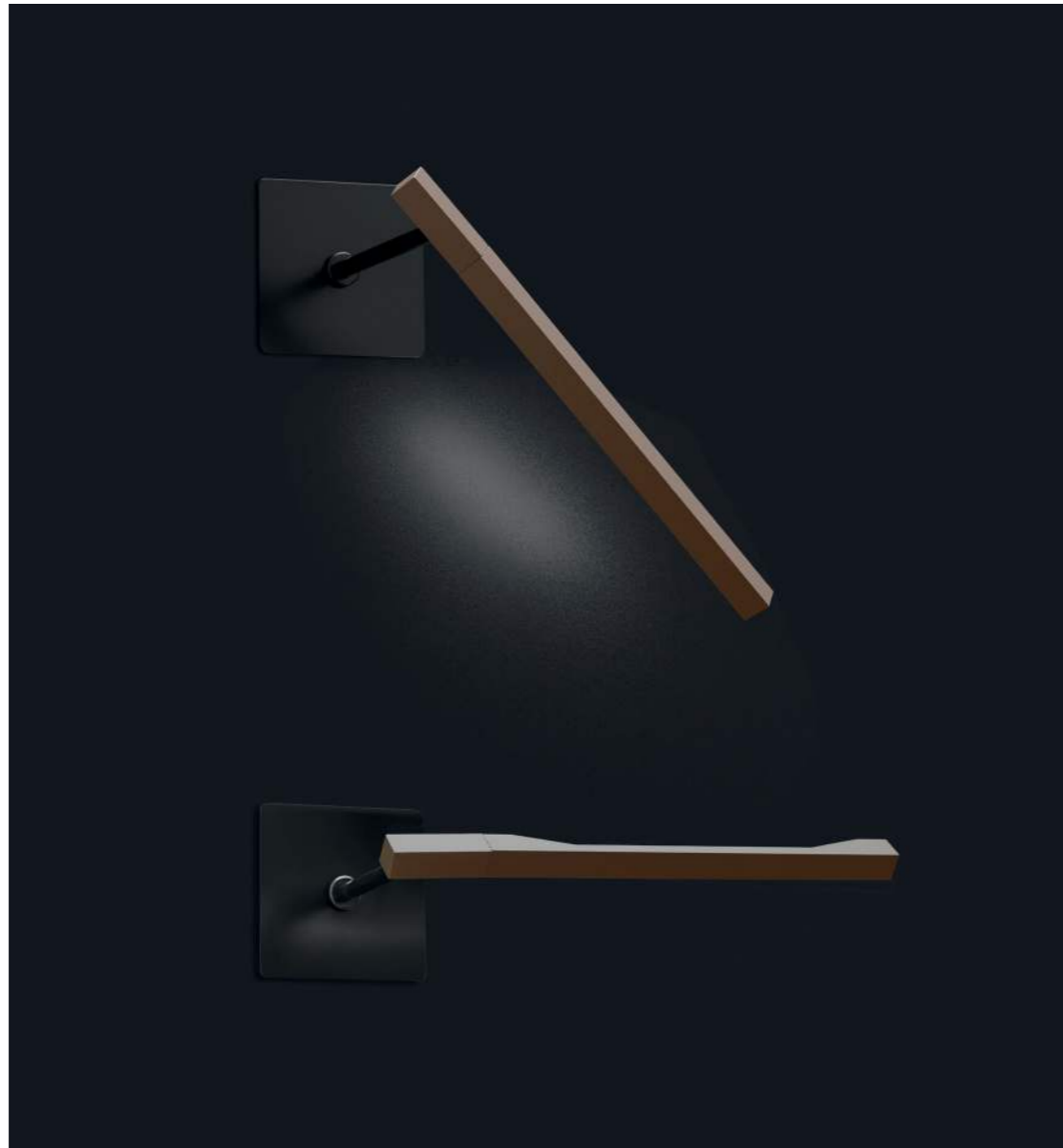

187

pagine/ pages

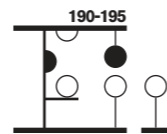
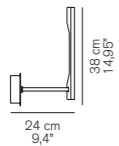

CODICE/CODE	SORGENTI/BULBS	MATERIALI/MATERIALS	COLORE/COLORS	MARCHI/MARKS
187	1 x max 4 W LED 2700° K 570 lm CRI > 85	metallo metal	anodizzato bronzo satinato /nero opaco anodized satin bronze /matt black	CE UL





BERLIN
Cristophe Pillet
2019



720

721

722

pagine/ pages

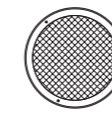

30 cm
11,8"

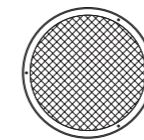

40 cm
15,7"

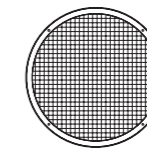

50 cm
19,7"

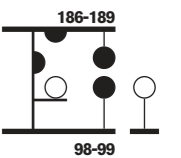

CODICE/CODE	SORGENTI/BULBS	MATERIALI/MATERIALS	COLORE/COLORS	MARCHI/MARKS
720	 2 x max 10W LED E14	metallo / vetro retinato sabbato metal / sand-blasted wired glass	anodizzato ottone satinato satin anodized brass	  
721	 2 x max 15W LED E27	metallo / vetro retinato sabbato metal / sand-blasted wired glass	anodizzato ottone satinato satin anodized brass	  
722	 4 x max 15W LED E27	metallo / vetro retinato sabbato metal / sand-blasted wired glass	anodizzato ottone satinato satin anodized brass	 





CALAMAIO

Cervellieri, Di Lorenzo,
Montini
2023

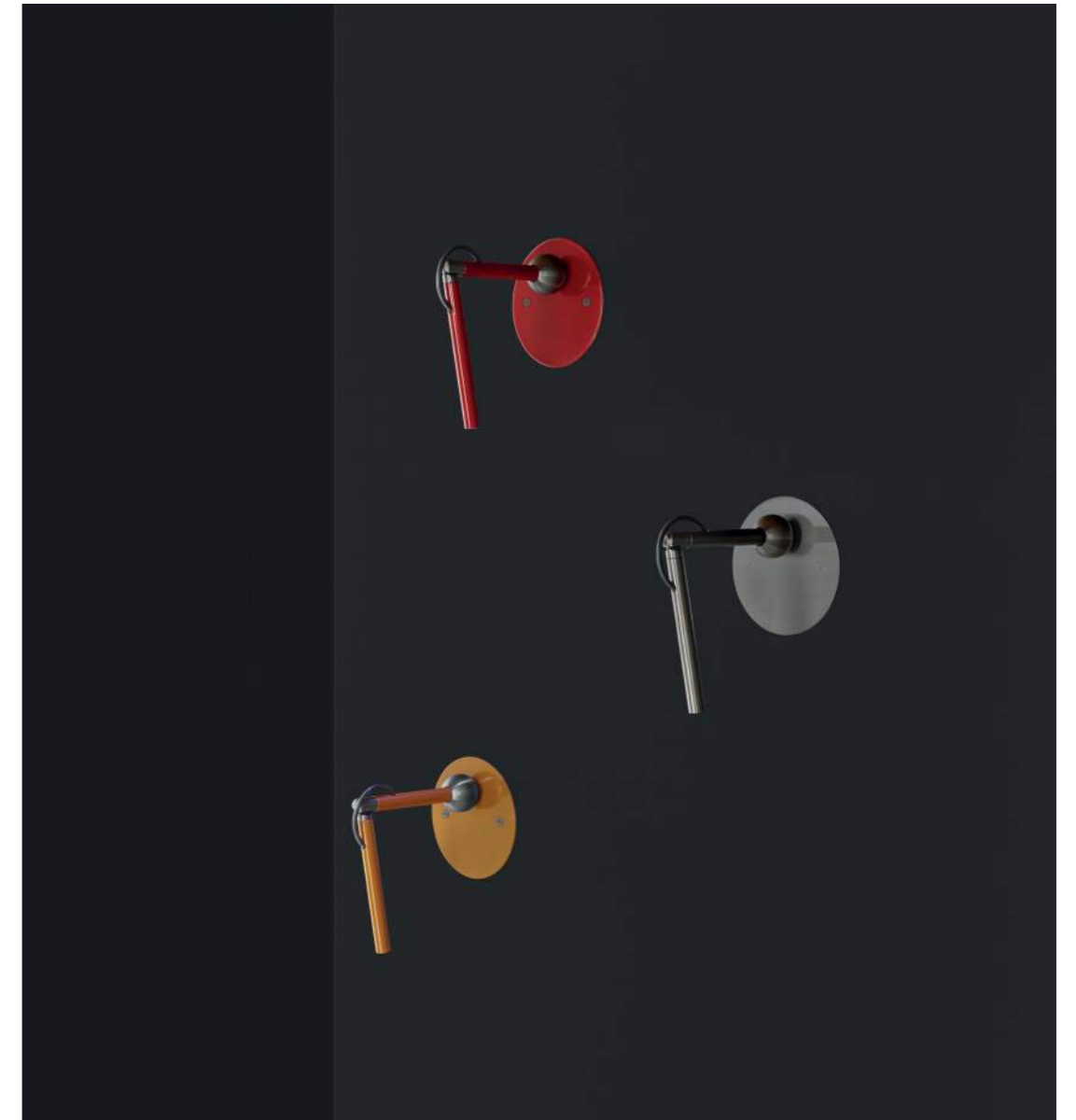

798

pagine/ pages

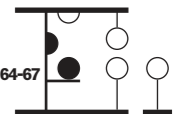
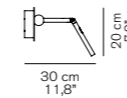

CODICE/CODE

SORGENTI/BULBS

MATERIALI/MATERIALS

COLORE/COLORS

MARCHI/MARKS

798



1 x 2 W - LED - 2700°K -
285 lm CRI>85

metal
metal

nickel nero satinato / rosso scarlet /
giallo mustard
satin black nickel / scarlet red /
mustard yellow





ALBA
Mariana
Pellegrino Soto
2019

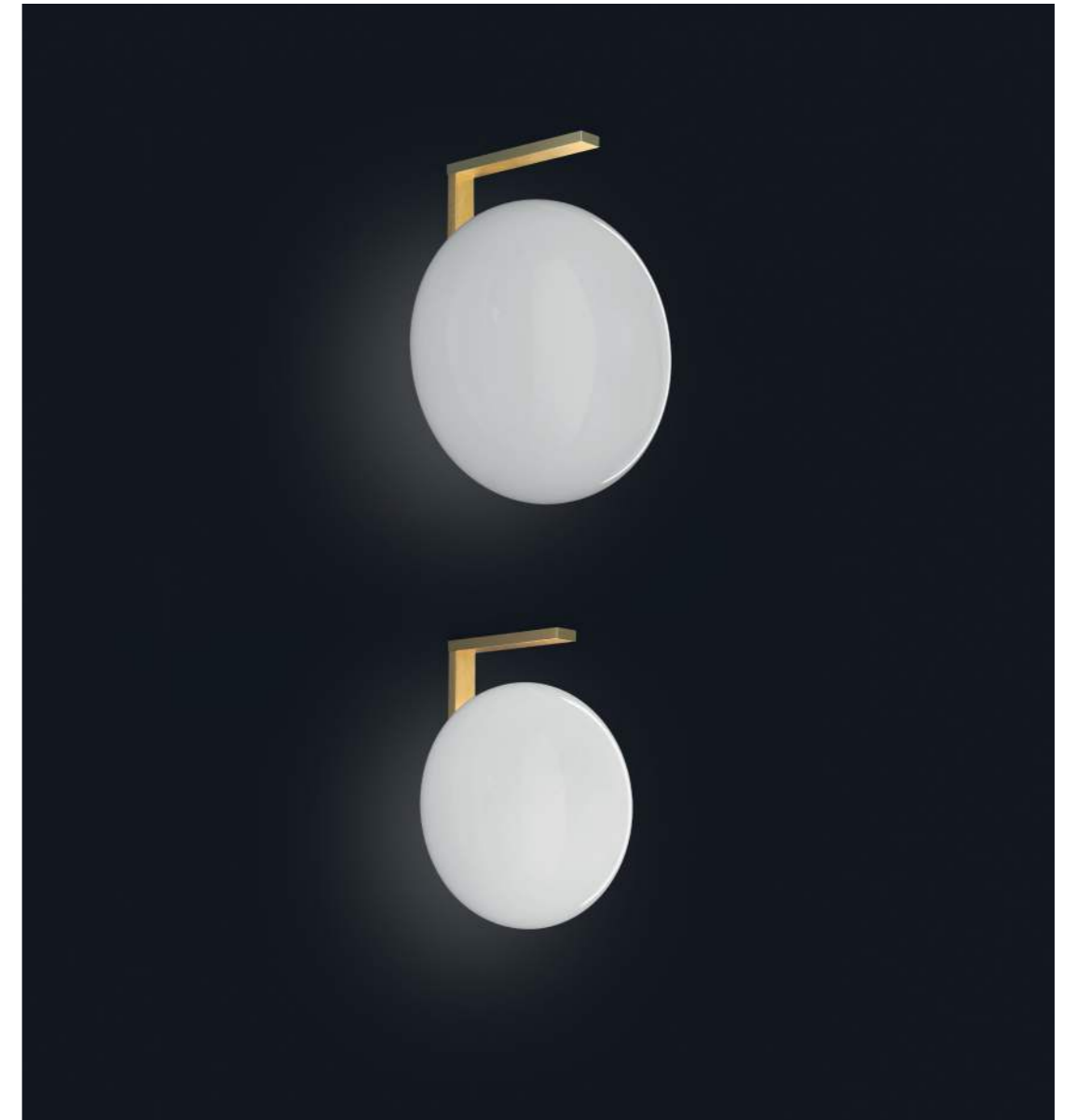







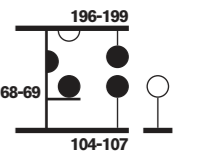
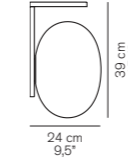
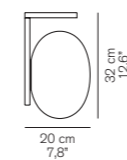



174

194

pagine/ pages



CODICE/CODE	SORGENTI/BULBES	MATERIALI/MATERIALS	COLORE/COLORS	MARCHI/MARKS
174	 1 x max 75 W  E27	metallo/vetro soffiato metal/blown-glass	anodizzato ottone satinato/opale lucido anodized satin brass/polished opaline	  
194	 1 x max 75 W  E27	metallo/vetro soffiato metal/blown-glass	anodizzato ottone satinato/opale lucido anodized satin brass/polished opaline	  

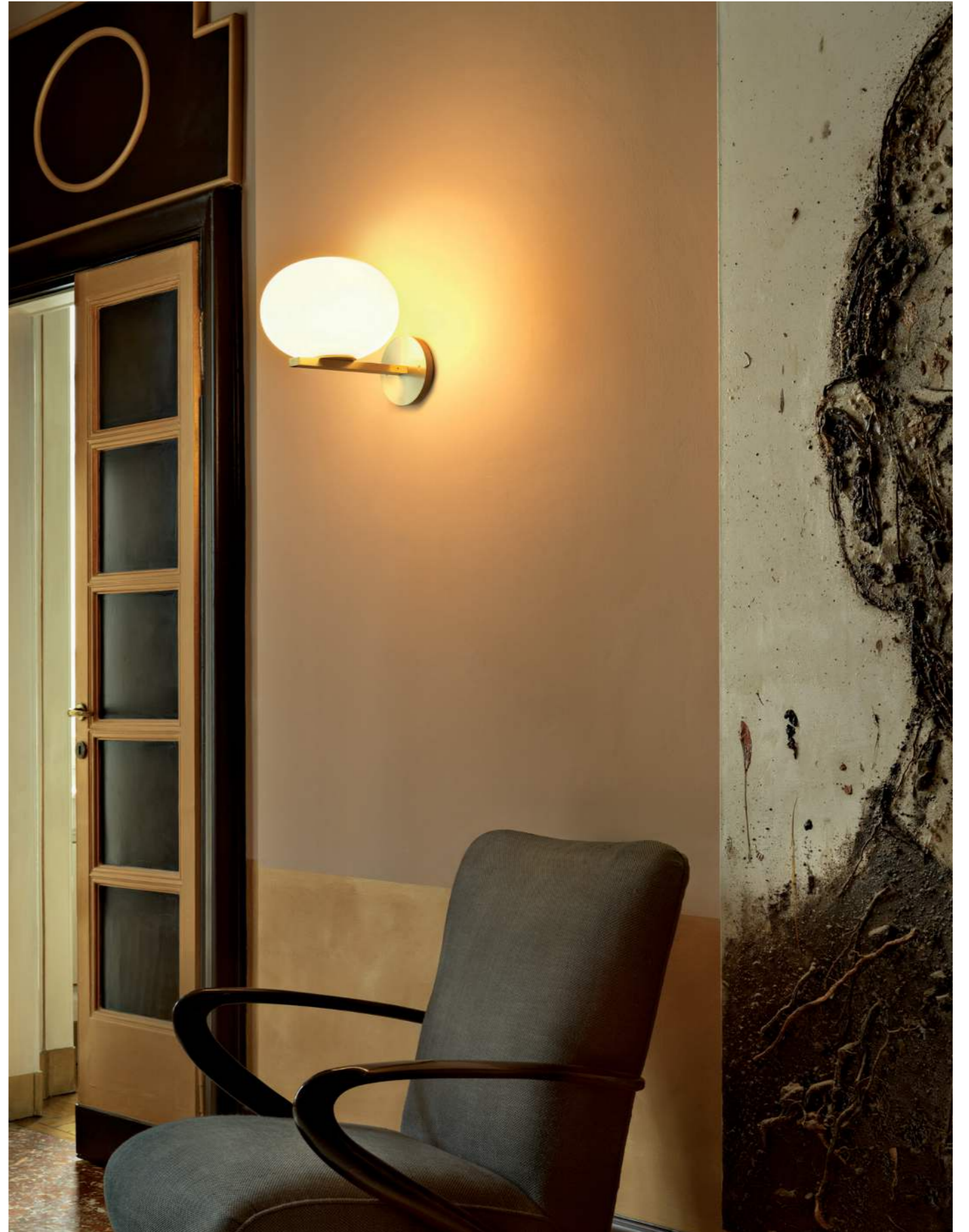

ALBA

Mariana
Pellegrino Soto
2017



176

pagine/ pages

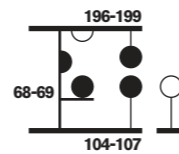
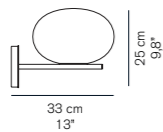

CODICE/CODE	SORGENTI/BULBS	MATERIALI/MATERIALS	COLORE/COLORS	MARCHI/MARKS
176	1 x max 60 W E27	metallo / vetro soffiato metal / blown-glass	anodizzato ottone satinato / opale lucido anodized satin brass / polished opaline	CE UL E27





THE GLOBE

Joe Colombo
1964



727

pagine/ pages

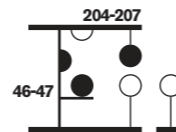
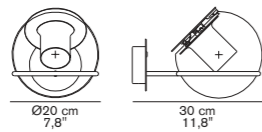

CODICE/CODE	SORGENTI/BULBS	MATERIALI/MATERIALS	COLORE/COLORS	MARCHI/MARKS
727	1 x max 40 W E14	metallo / vetro soffiato metal / blown glass	nickel satinato - oro satinato / bronzo anodic satin nickel - satin gold / anodic bronze	CE UL ENEC

LENS

Francesco Rota
2013

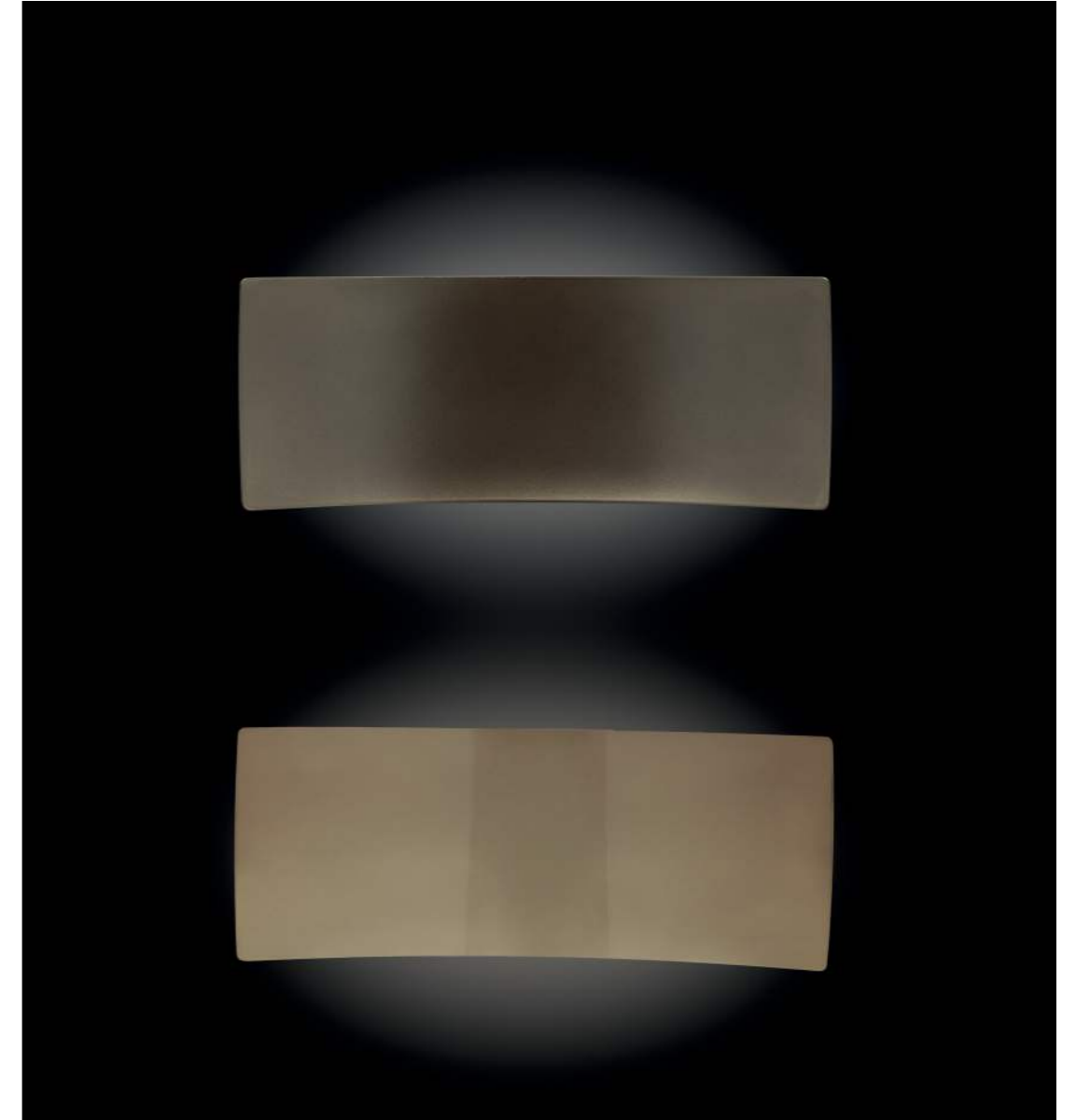

151

pagine/ pages

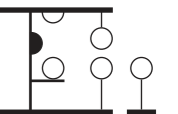
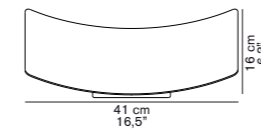

CODICE/CODE	SORGENTI/BULBS	MATERIALI/MATERIALS	COLORE/COLORS	MARCHI/MARKS
151	1 x max 120 W R7s.15	metallo metal	bronzo anodic - oro satinato smaltato anodic bronze - satin gold glaze	CE



COUPÈ
Joe Colombo
1967



1158

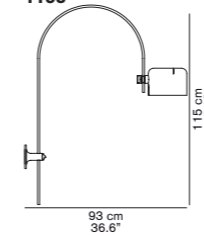

pagine/pages

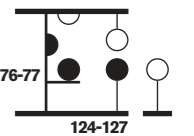

CODICE/CODE

SORGENTI/BULBS

MATERIALI/MATERIALS

COLORE/COLORS

MARCHI/MARKS

1158

✱ 1 x max 100 W
E27

metallo/alluminio
metal/aluminium

nero/rosso scarlet
black/scarlet red

CE



COUPÈ

Joe Colombo
1967



1159/R

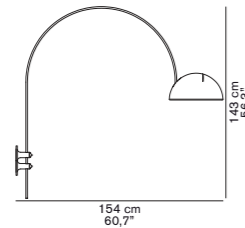

pagine/ pages

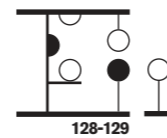

CODICE/CODE	SORGENTI/BULBS	MATERIALI/MATERIALS	COLORE/COLORS	MARCHI/MARKS
1159/R	1 x max 100 W E27	metallo /alluminio metal /aluminium	bianco /nero white /black	CE

COLOMBO

Joe Colombo
1970

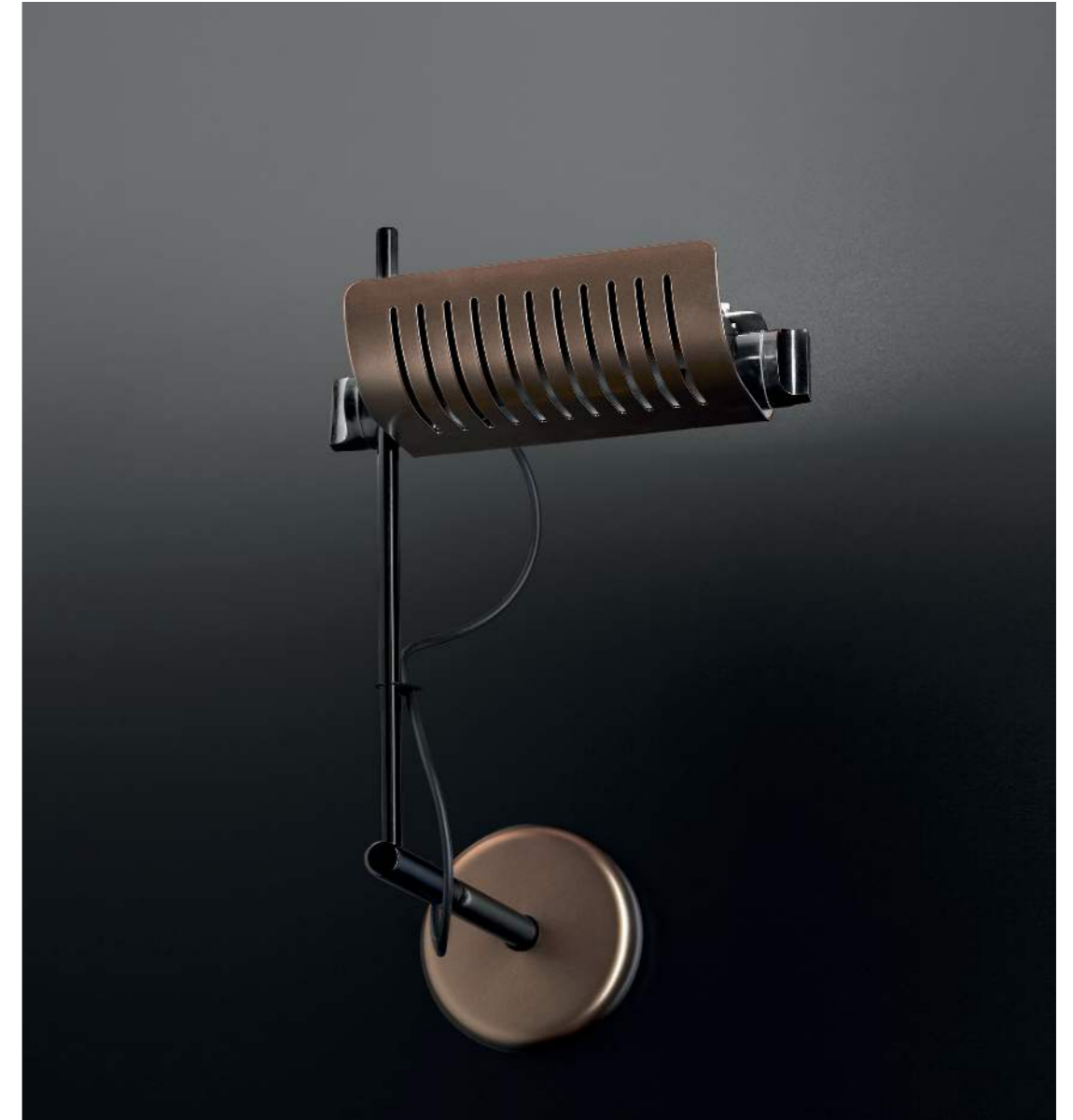

761/L

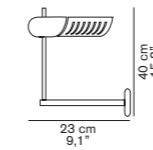

pagine/ pages

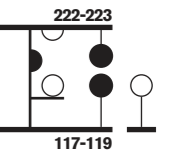

CODICE/CODE	SORGENTI/BULBS	MATERIALI/MATERIALS	COLORE/COLORS	MARCHI/MARKS
761/L	1 x max 24 W LED 2700°K 4100 lm CRI >85	metallo /alluminio metal /aluminium	nero asta cromo - bronzo anodic asta nera - rosso scarlet asta cromo black stem chrome - anodic bronze stem black - scarlet red stem chrome	CE





FRESNEL

Joe Colombo
1966



1148 – 1148/LBT

pagine/ pages

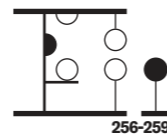

CODICE/CODE	SORGENTI/BULBS	MATERIALI/MATERIALS	COLORE/COLORS	MARCHI/MARKS
1148	1 x max 40 W E14	metallo /vetro trasparente sabbiato metal /glass sand blasted transparent	bianco /nero /grigio /cromato white /black /grey /chromium plated	CE UL
1148/LBT	1 x max 4 W LED 2700°K 600 lm CRI >85	metallo /vetro trasparente sabbiato metal /glass sand blasted transparent	bianco /nero /grigio /cromato white /black /grey /chromium plated	CE



YOLK
 angelettiruzza design
 2014

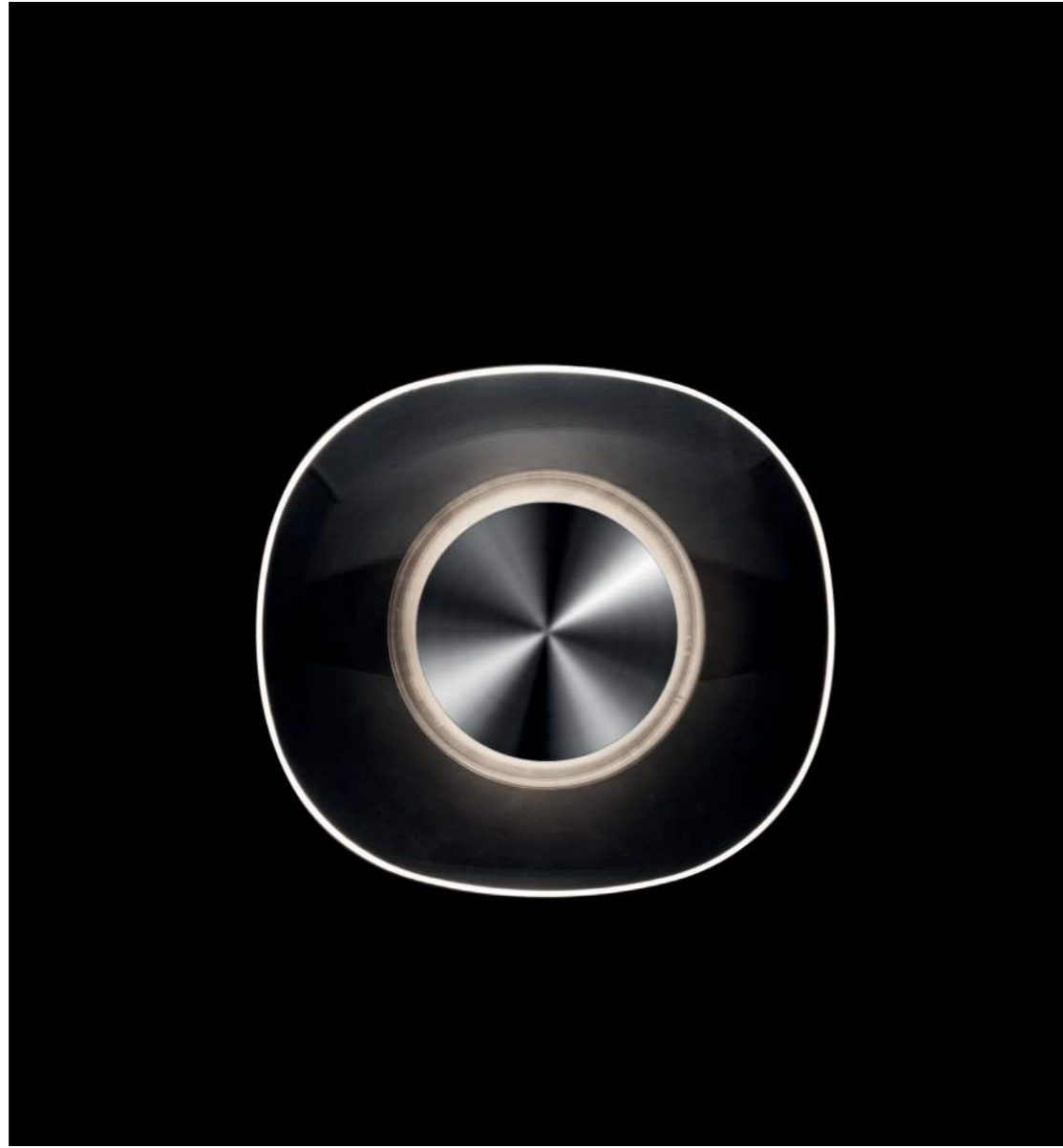

169

pagine/ pages

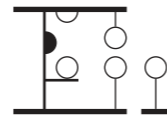
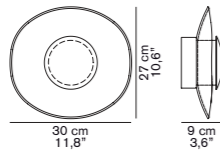

CODICE/CODE	SORGENTI/BULBS	MATERIALI/MATERIALS	COLORE/COLORS	MARCHI/MARKS
169	1 x max 60 W G9	metallo/vetro soffiato metal/blown glass	trasparente/opale transparent/opaline	CE

KELLY
 Studio 63
 2011



791

pagine/ pages

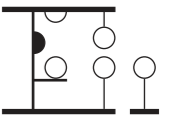
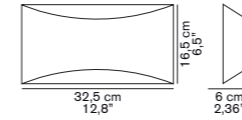

CODICE/CODE	SORGENTI/BULBS	MATERIALI/MATERIALS	COLORE/COLORS	MARCHI/MARKS
791	2 x max 6 W LED 3000° K 2 x 770 lm CRI >85	metallo/metallo metal/metal	bianco/cromato white/chromium plated	CE



LINE
 Francesco Rota
 2009









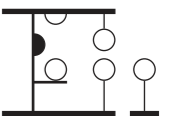
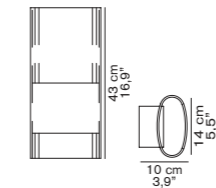
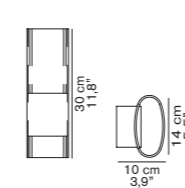

147

149

pagine/ pages



CODICE/CODE	SORGENTI/BULBS	MATERIALI/MATERIALS	COLORE/COLORS	MARCHI/MARKS
147	 2 x max 40 W  G9	alluminio / vetro pyrex <i>aluminium / pyrex glass</i>	trasparente <i>transparent</i>	 
149	 2 x max 40 W  G9	alluminio / vetro pyrex <i>aluminium / pyrex glass</i>	trasparente <i>transparent</i>	 



LYNDON

Vico Magistretti
1977



160

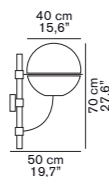

160/M

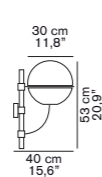

pagine/pages

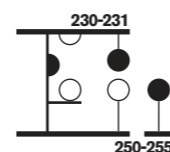

CODICE/CODE	SORGENTI/BULBS	MATERIALI/MATERIALS	COLORE/COLORS	MARCHI/MARKS
160	1 x max 100 W E27	metallo / policarbonato metal / polycarbonate	nero / trasparente black / transparent	CE
160/M	1 x max 100 W E27	metallo / policarbonato metal / polycarbonate	nero / trasparente black / transparent	CE



FIORE

Laudani & Romanelli
2007

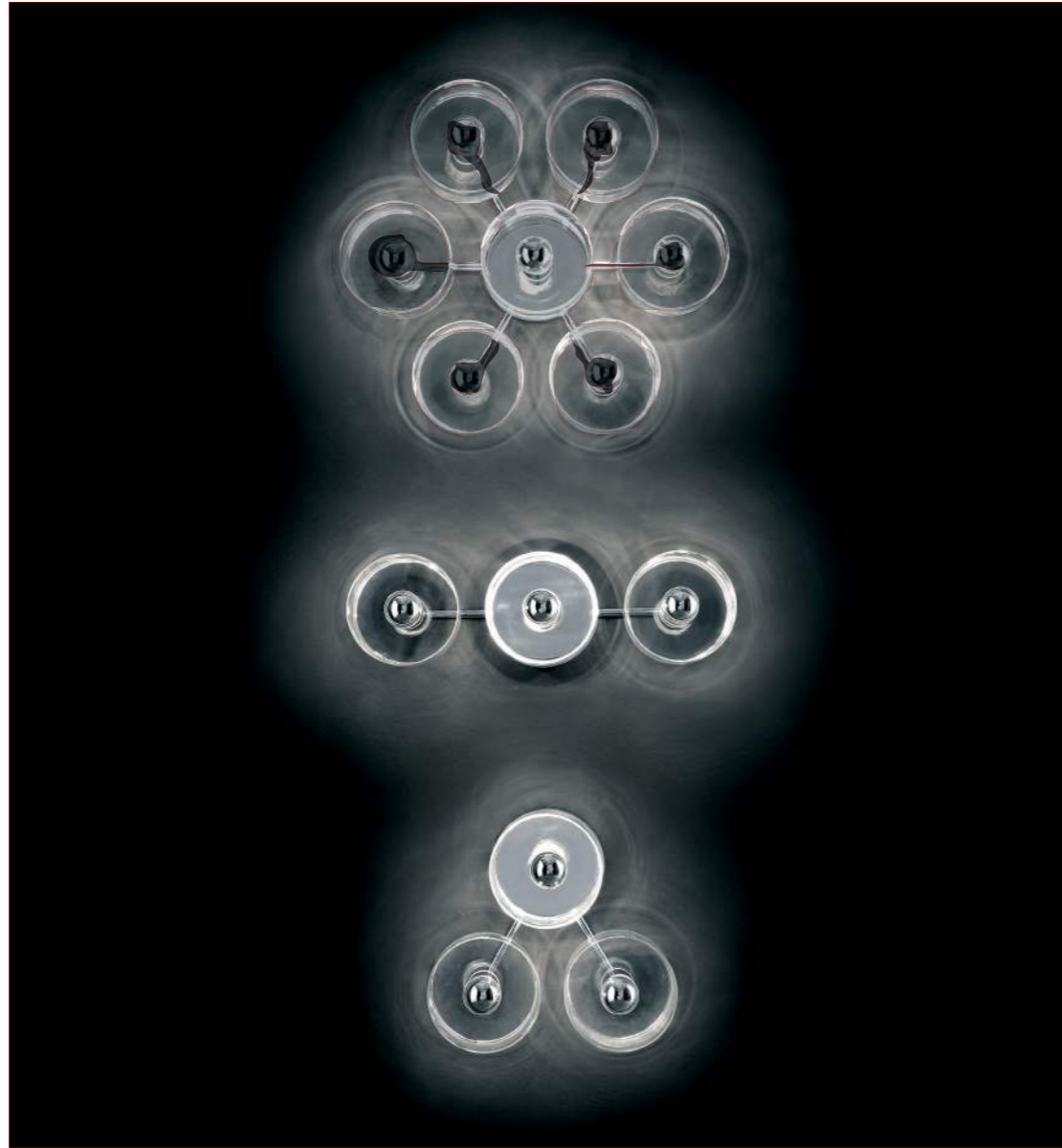

103

123

173

139

pagine/pages

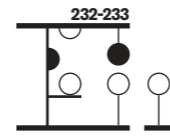
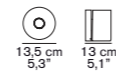
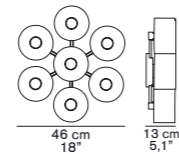
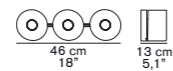
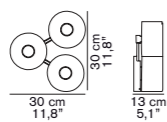

CODICE/CODE	SORGENTI/BULBS	MATERIALI/MATERIALS	COLORE/COLORS	MARCHI/MARKS
103	3 x max 40 W E14	metallo /vetro soffiato metal /blown glass	trasparente transparent	CE UL
123	3 x max 40 W E14	metallo /vetro soffiato metal /blown glass	trasparente transparent	CE UL
173	7 x max 40 W E14	metallo /vetro soffiato metal /blown glass	trasparente transparent	CE UL
139	1 x max 40 W E14	metallo /vetro soffiato metal /blown glass	trasparente transparent	CE UL

PLUME

Christophe Pillet
2017



158

159

pagine/pages

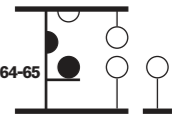
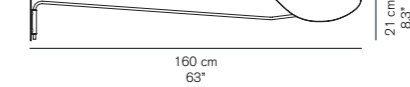
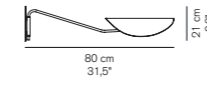

CODICE/CODE	SORGENTI/BULBS	MATERIALI/MATERIALS	COLORE/COLORS	MARCHI/MARKS
158	1 x max 40W E14	metallo metal	bronzo anodic anodic bronze	CE
159	1 x max 60W E27	metallo metal	bronzo anodic anodic bronze	CE



ASTRO

Giopato & Coombes
2015



1188

pagine/pages

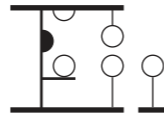
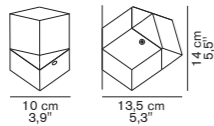

CODICE/CODE	SORGENTI/BULBS	MATERIALI/MATERIALS	COLORE/COLORS	MARCHI/MARKS
1188	1 x max 33 W G9	metallo / vetro stampato metal / moulded glass	bianco / nero / trasparente white / black / transparent	CE ECC



lampade a sospensione

/ suspension lamps

- | | | | |
|-----|---------------|-----|------------|
| 186 | BERLIN | 224 | KIN |
| 190 | ILO | 226 | CANOPY |
| 196 | ALBA | 230 | LYNDON |
| 200 | DANCING QUEEN | 232 | FIORE |
| 204 | THE GLOBE | 234 | RECUERDO |
| 208 | IRIDE | 236 | NIWA |
| 212 | SONORA | 238 | LANTERNA / |
| 222 | COLOMBO | | LANTERNINA |





BERLIN
 Christophe Pillet
 2023

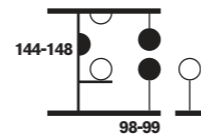
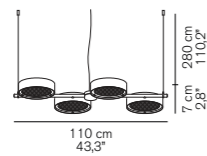

823

pagine/ pages



CODICE/CODE	SORGENTI/BULBS	MATERIALI/MATERIALS	COLORE/COLORS	MARCHI/MARKS
823	 4 x 15 W - LED - 2700°K - 8600 lm - CRI>85	metallo/vetro retinato sabbiato <i>metal/sand-blasted wired glass</i>	nero opaco/nero opaco - anodizzato ottone <i>matt black/matt black - anodized brass</i>	





ILO
David Lopez
Quincoces
2019

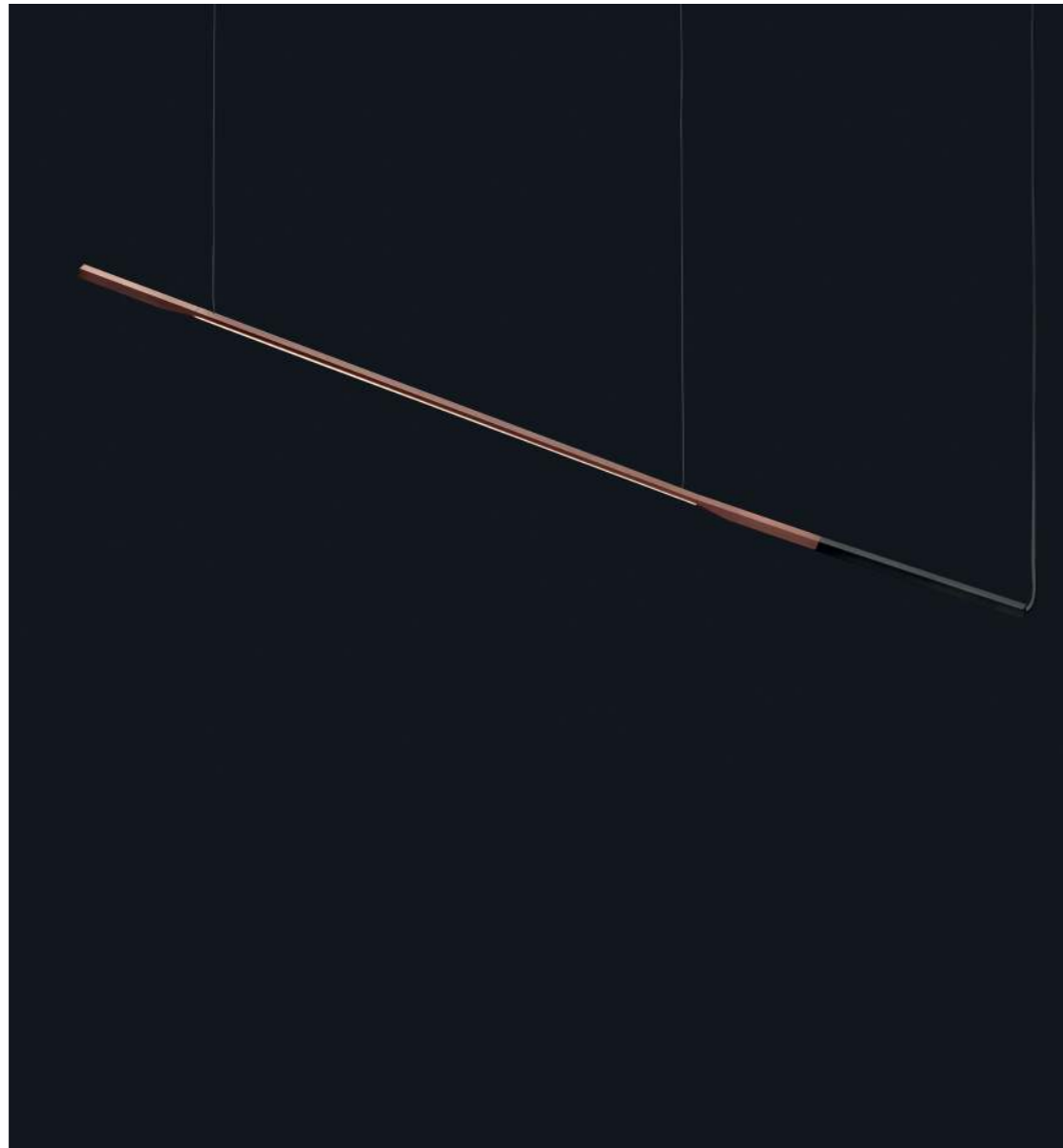

487

pagine/ pages

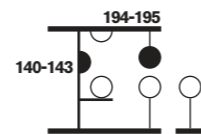
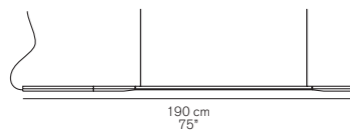

CODICE/CODE	SORGENTI/BULBES	MATERIALI/MATERIALS	COLORE/COLORS	MARCHI/MARKS
487	1 x max 25 W LED 2700° K 2750 lm CRI >85	metallo metal	anodizzato bronzo satinato /nero opaco anodized satin bronze /matt black	CE





ILO
David Lopez
Quincoces
2019

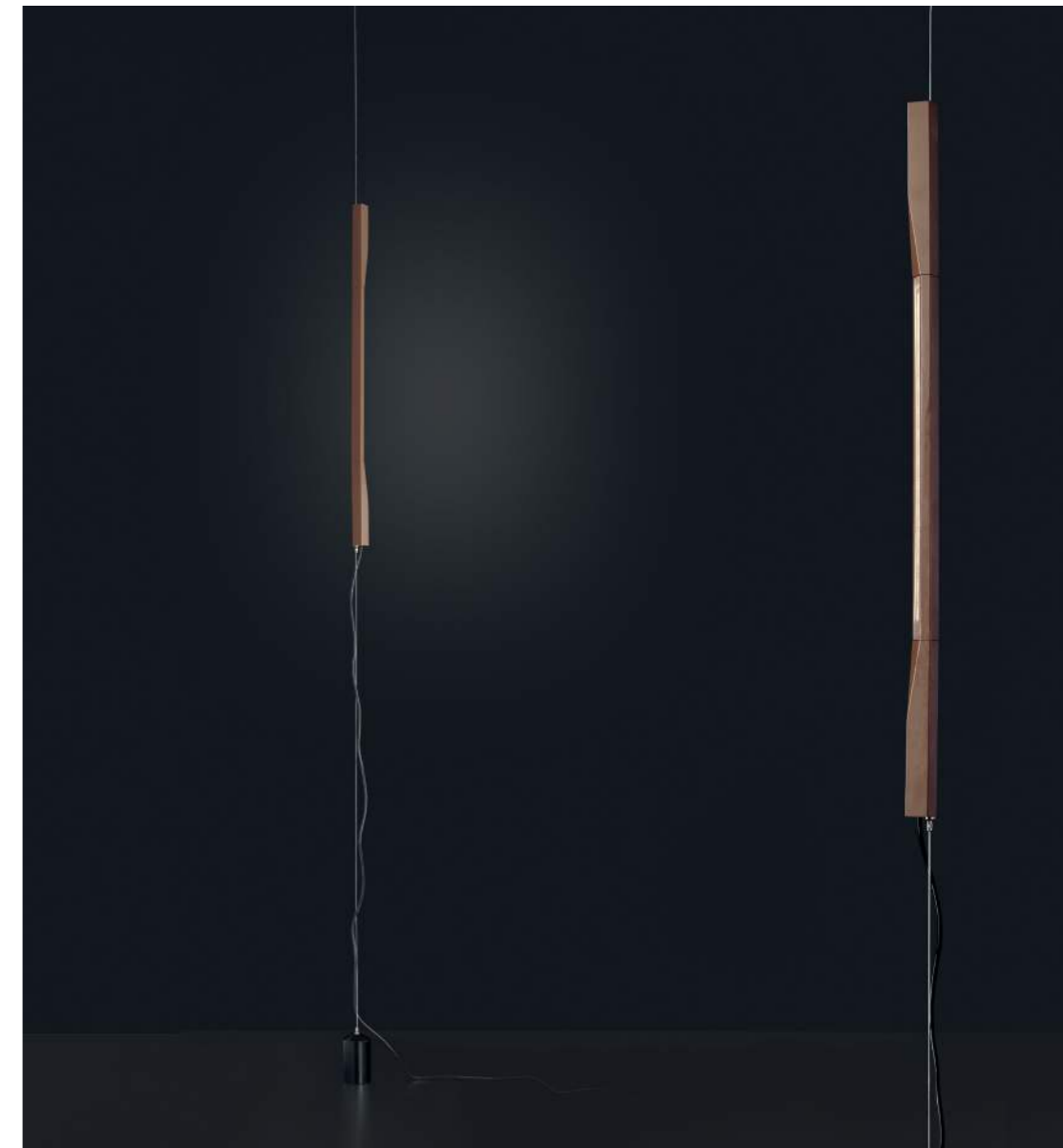

467

pagine/pages

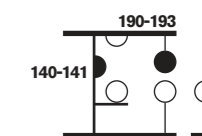
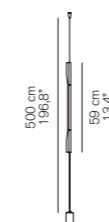

CODICE/CODE	SORGENTI/BULBES	MATERIALI/MATERIALS	COLORE/COLORS	MARCHI/MARKS
467	 1 x max 8 W LED  2700° K 1100 lm CRI >85	metallo <i>metal</i>	anodizzato bronzo satinato /nero opaco <i>anodized satin bronze /matt black</i>	



ALBA
Mariana
Pellegrino Soto
2017

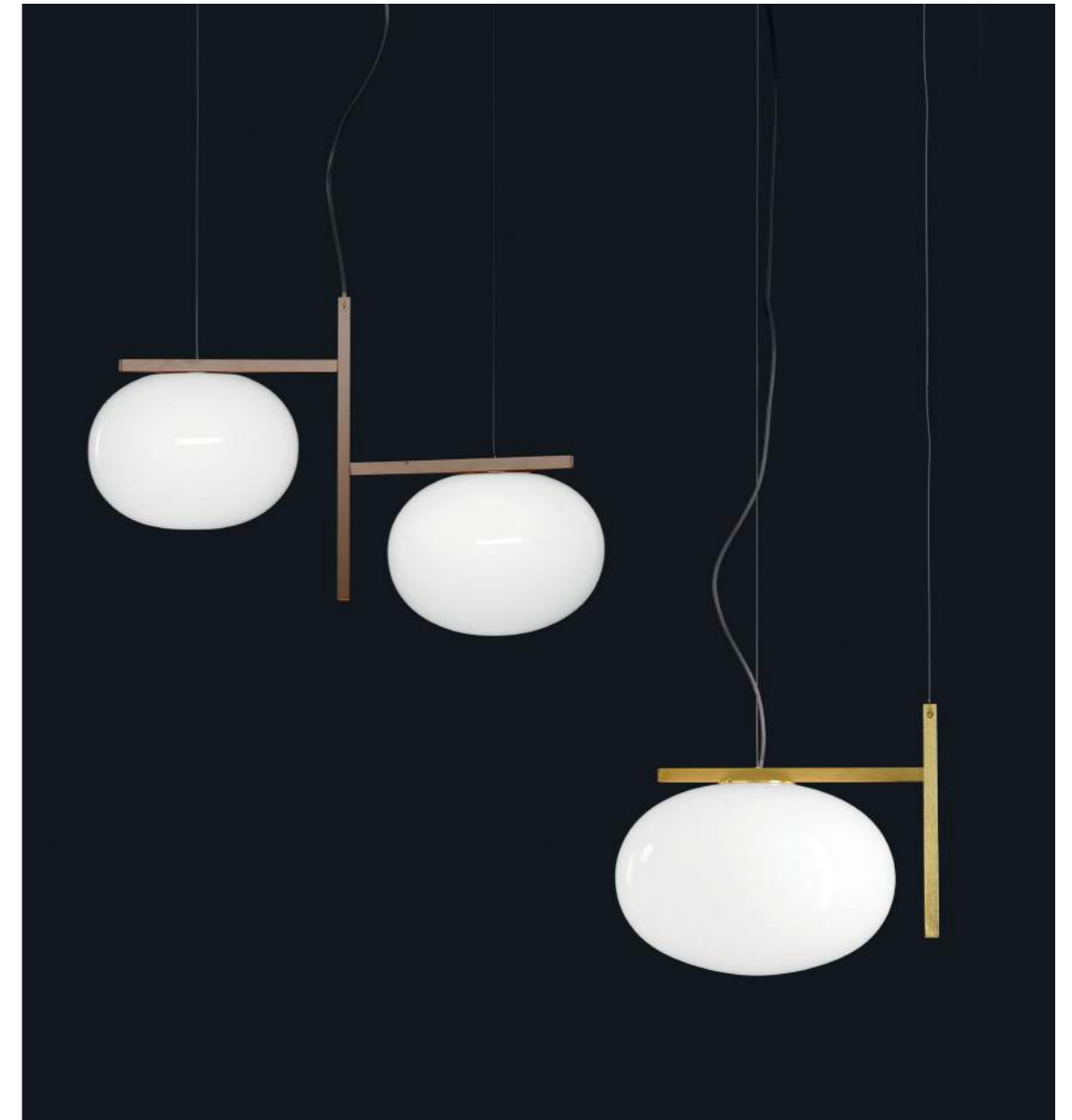

465

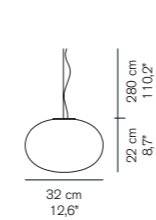

466

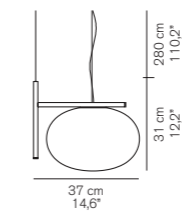

468

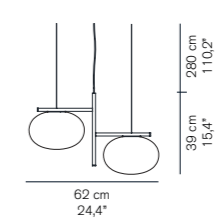

pagine/pages

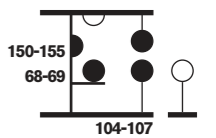

CODICE/CODE

SORGENTI/BULBS

MATERIALI/MATERIALS

COLORE/COLORS

MARCHI/MARKS

465

☀ 1 x max 75 W
💡 E27

metallo / vetro soffiato
metal / blown-glass

anodizzato ottone / opale lucido
anodized brass / polished opaline

CE UH CCC

466

☀ 1 x max 75 W
💡 E27

metallo / vetro soffiato
metal / blown-glass

anodizzato ottone / opale lucido
anodized brass / polished opaline
bronzo anodizzato / opale lucido
anodic bronze / polished opaline

CE UH CCC

468

☀ 2 x max 75 W
💡 E27

metallo / vetro soffiato
metal / blown-glass

anodizzato ottone / opale lucido
anodized brass / polished opaline
bronzo anodizzato / opale lucido
anodic bronze / polished opaline

CE UH CCC



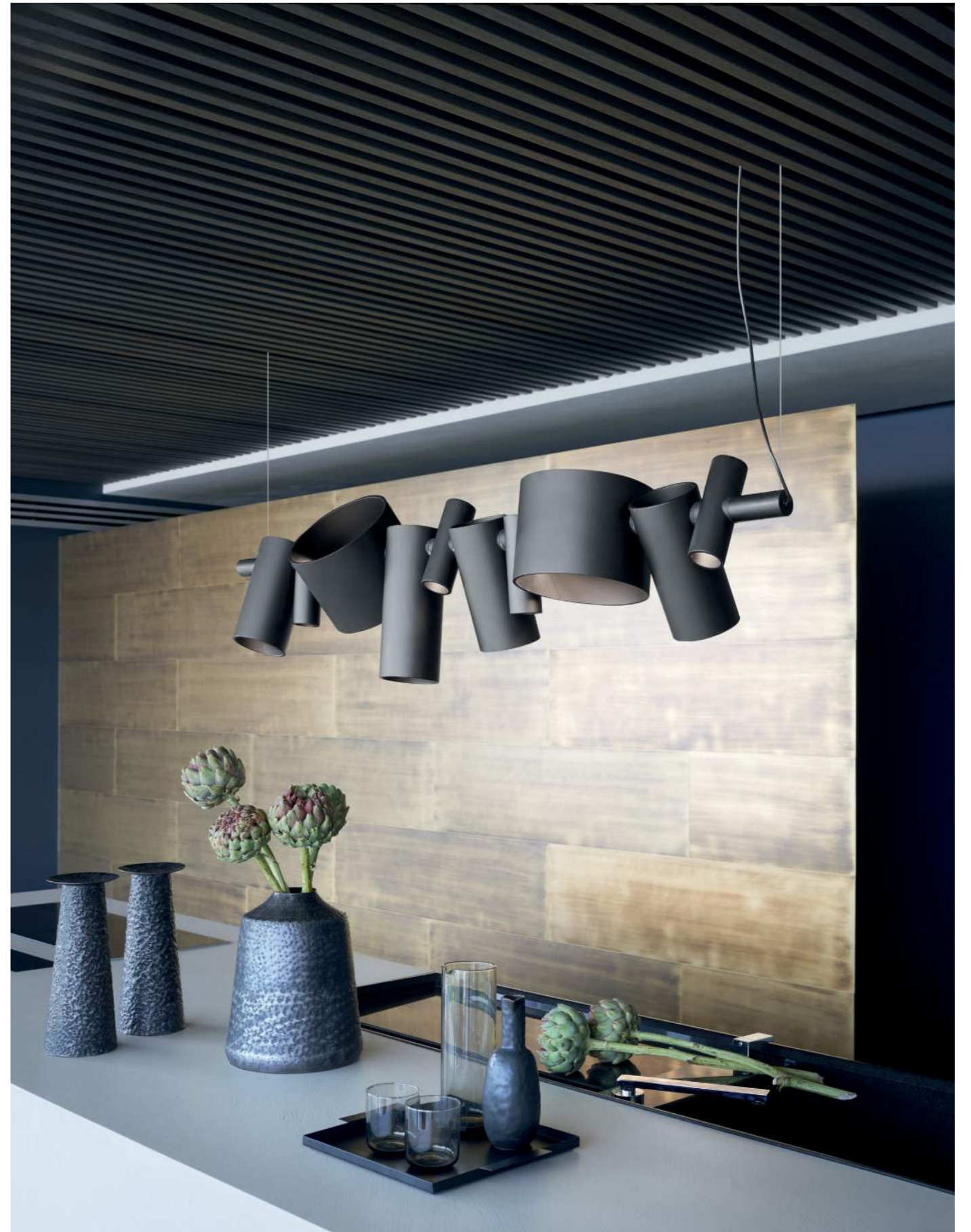

DANCING QUEEN



Victor Vasilev
2023

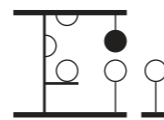
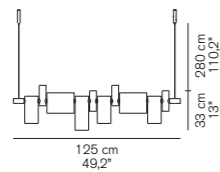

456

pagine/pages



CODICE/CODE	SORGENTI/BULBS	MATERIALI/MATERIALS	COLORE/COLORS	MARCHI/MARKS
456	 1 x 30 W - LED - 2700°K - 3300 lm - CRI>85 + 1 x 25 W - LED -2700°K - 2750 lm - CRI>85	metallo <i>metal</i>	nero opaco /grigio lucido <i>matt black /lacquered grey</i>	





THE GLOBE

Joe Colombo
1964

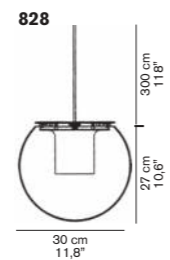
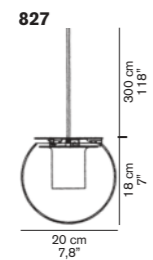

pagine/ pages

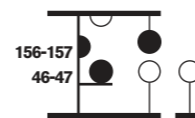

CODICE/CODE	SORGENTI/BULBS	MATERIALI/MATERIALS	COLORE/COLORS	MARCHI/MARKS
827	1 x max 40 W E14	metallo/vetro soffiato <i>metal/blown glass</i>	nickel satinato - oro satinato /anodic bronzo <i>satin nickel - satin gold/anodic bronze</i>	
828	1 x max 60 W E27	metallo/vetro soffiato <i>metal/blown glass</i>	nickel satinato - oro satinato /anodic bronzo <i>satin nickel - satin gold/anodic bronze</i>	





IRIDE

Bellucci Mazzoni
Progetti
2023



878

879

pagine/pages

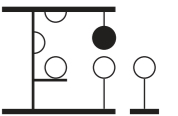
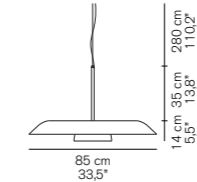
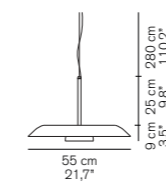

CODICE/CODE

SORGENTI/BULBS

MATERIALI/MATERIALS

COLORE/COLORS

MARCHI/MARKS

878



1 x 11 W - LED - 2700°K -
1600 lm CRI>85

metallo/vetro
metal/glass

bianco lucido/nero lucido/rosso scarlet
lacquered white/lacquered black/scarlet red



879



1 x 21 W - LED - 2700°K -
3000 lm - CRI>85

metallo/vetro
metal/glass

bianco lucido/nero lucido/rosso scarlet
lacquered white/lacquered black/scarlet red







SONORA
Vico Magistretti
1976



408

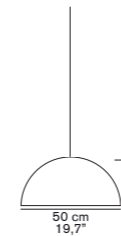



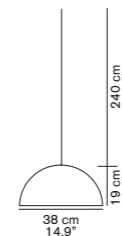

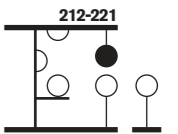

437



pagine/ pages



CODICE/CODE	SORGENTI/BULBS	MATERIALI/MATERIALS	COLORE/COLORS	MARCHI/MARKS
408	 1 x max 60 W  E27	metallo metal	nero – oro satinato black – satin gold	CE 
437	 1 x max 60 W  E27	metallo metal	nero – oro satinato black – satin gold	CE 



SONORA
Vico Magistretti
1976



490 - 490/OR

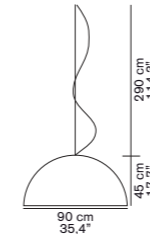

493

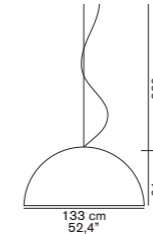

pagine/ pages

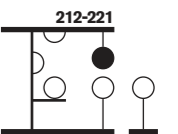

CODICE/CODE	SORGENTI/BULBS	MATERIALI/MATERIALS	COLORE/COLORS	MARCHI/MARKS
490	1 x max 150 W E27	metallo /PMMA metal /PMMA	opale /bianco coprente /nero opaline /painted white /black	CE UH ecc
490/OR	1 x max 150 W E27	metallo /PMMA metal /PMMA	esterno bianco /nero - interno foglia oro white outside /black - gold leaf inside	CE UH ecc
493	2 x max 150 W E27	metallo /PMMA metal /PMMA	opale /bianco coprente opaline /painted white	CE UH ecc





SONORA
Vico Magistretti
1976



411

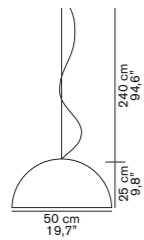

438

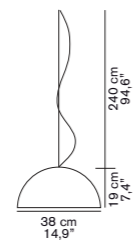

pagine/pages

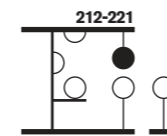

CODICE/CODE	SORGENTI/BULBS	MATERIALI/MATERIALS	COLORE/COLORS	MARCHI/MARKS
411	2 x max 100 W E27	metallo / vetro soffiato metal / blown glass	opale acidato opaline opaque	
438	1 x max 100 W E27	metallo / vetro soffiato metal / blown glass	opale acidato opaline opaque	



COLOMBO 885

Joe Colombo
1970

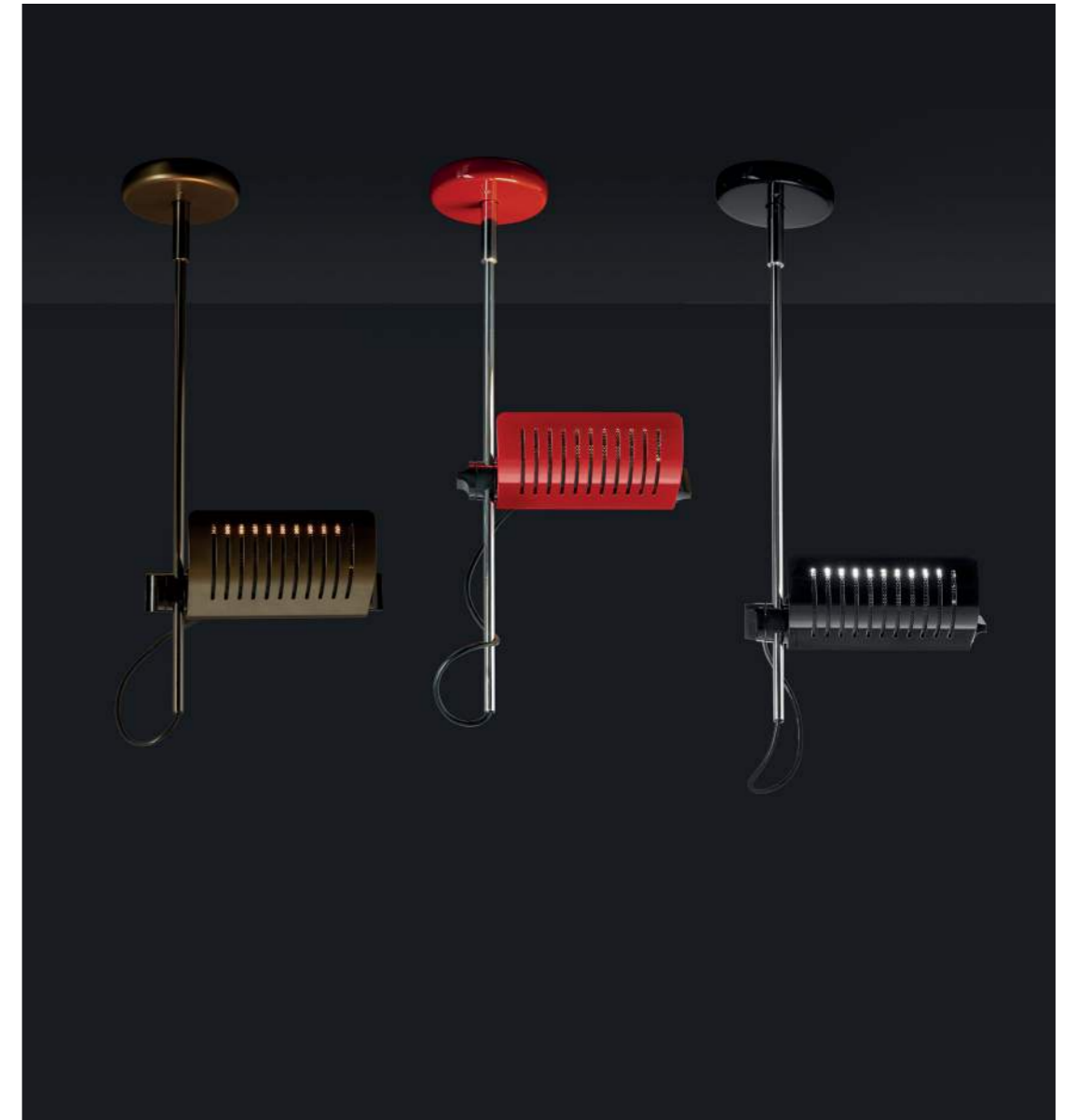

885/L

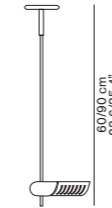

pagine/ pages

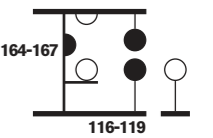

CODICE/CODE

885 /L



SORGENTI/BULBS

1 x max 24 W LED
2700°K 4100 lm CRI >85

MATERIALI/MATERIALS

metallo /alluminio
metal /aluminium

COLORE/COLORS

nero asta cromo - bronzo anodic asta nera -
rosso scarlet asta cromo
black stem chrome - anodic bronze
stem black - scarlet red stem chrome

MARCHI/MARKS





KIN
 Francesco Rota
 2012



478/LBT

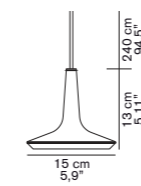

479/LBT

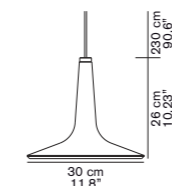

pagine/ pages

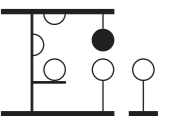

CODICE/CODE	SORGENTI/BULBS	MATERIALI/MATERIALS	COLORE/COLORS	MARCHI/MARKS
478/LBT	☀ 1 x max 4 W (LED) 2700°K 600 lm CRI>85	metallo/PMMA metal/PMMA	bronzo anodic - oro satinato smaltato anodic bronze - satin gold glaze	CE
479/LBT	☀ 1 x max 8,5 W (LED) 2700°K 1330 lm CRI>85	metallo/PMMA metal/PMMA	bronzo anodic - oro satinato smaltato anodic bronze - satin gold glaze	CE



CANOPY
 Francesco Rota
 2009

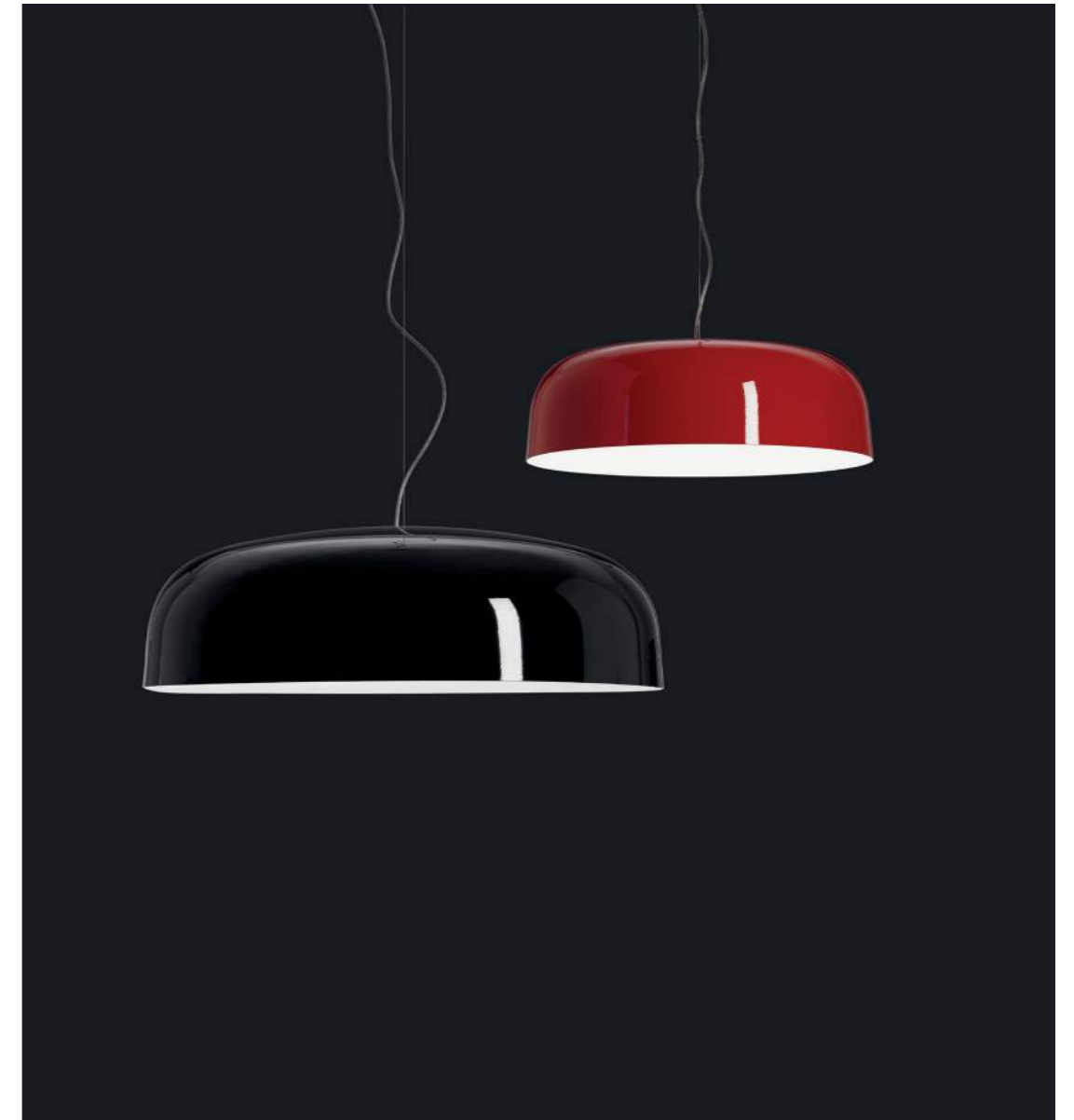

421/L

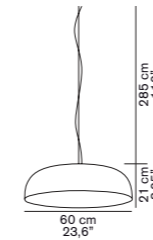



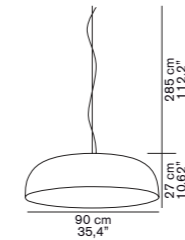

422/L

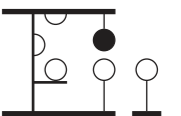

pagine/ pages



CODICE/CODE	SORGENTI/BULBS	MATERIALI/MATERIALS	COLORE/COLORS	MARCHI/MARKS
421/L	 1 x max 25 W (LED)  3000°K 4500 lm CRI>85	alluminio aluminium	nero/rosso scarlet black/scarlet red	CE
422/L	 1 x max 25 W (LED)  3000°K 4500 lm CRI>85	alluminio aluminium	nero/rosso scarlet black/scarlet red	CE



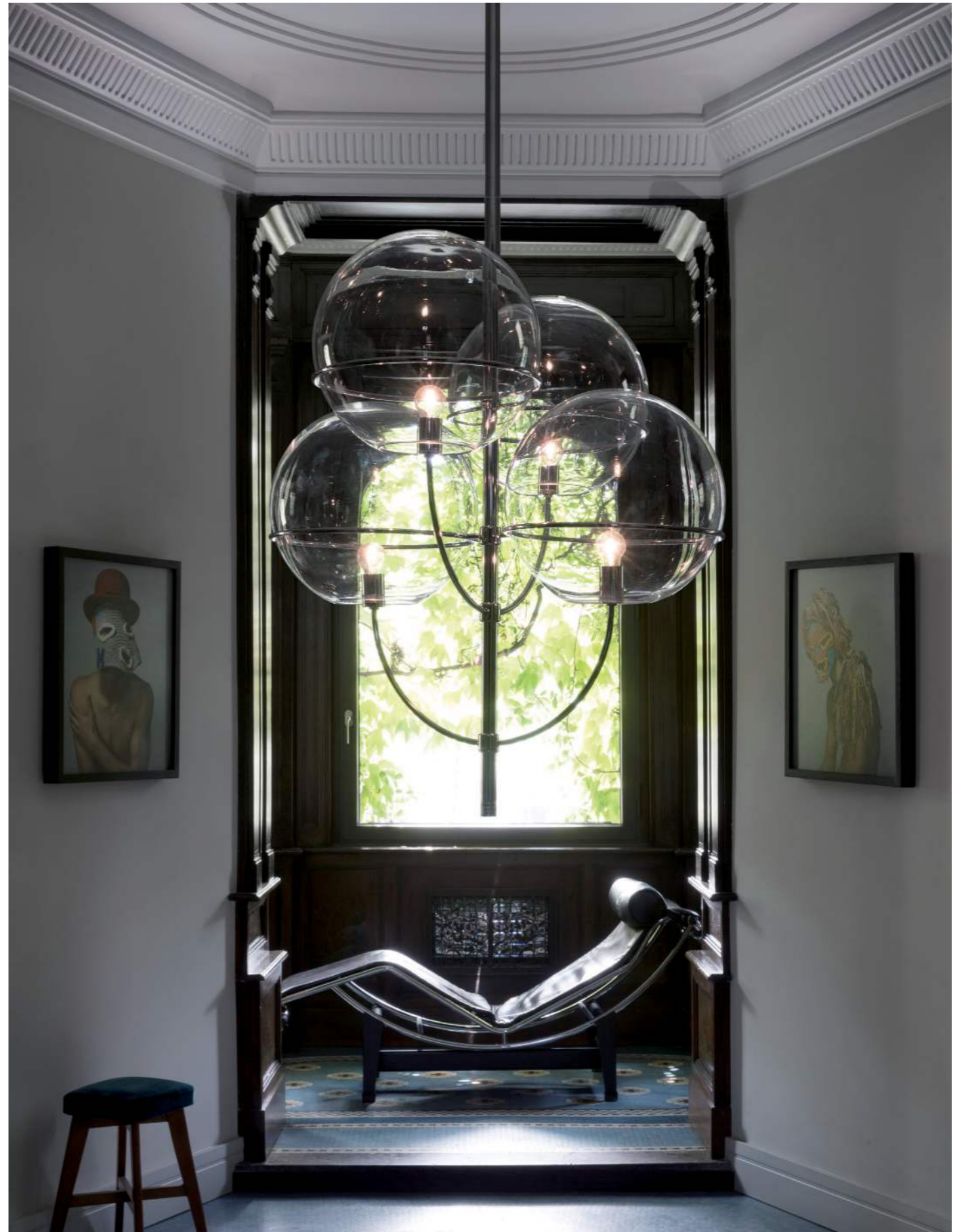

LYNDON

Vico Magistretti
1977



450

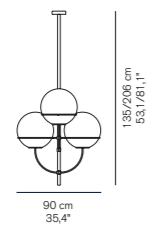

pagine/pages

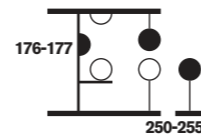

CODICE/CODE	SORGENTI/BULBS	MATERIALI/MATERIALS	COLORE/COLORS	MARCHI/MARKS
450	4 x max 100 W E27	metallo/vetro metal/glass	cromato - oro satinato chromium - plated - satin gold	CE UL ENEC

FIORE

Laudani & Romanelli
2007



423

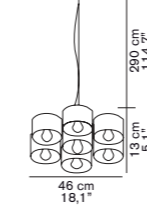

433

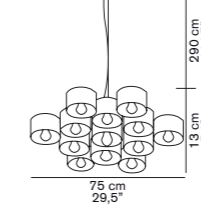

pagine/pages

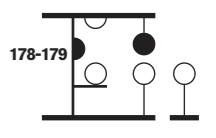

CODICE/CODE	SORGENTI/BULBS	MATERIALI/MATERIALS	COLORE/COLORS	MARCHI/MARKS
423	7 x max 40 W E14	metallo/vetro soffiato metal/blown glass	trasparente transparent	CE UL
433	13 x max 25 W E14	metallo/vetro soffiato metal/blown glass	trasparente transparent	CE UL



RECUERDO

Mariana
Pellegrino Soto
2017



484

pagine/pages

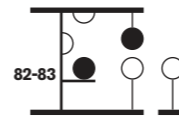
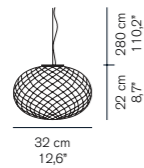

CODICE/CODE	SORGENTI/BULBS	MATERIALI/MATERIALS	COLORE/COLORS	MARCHI/MARKS
484	 1 x max 12 W LED 220 V 3000° K 1130 lm CRI >85	vetro soffiato/alluminio <i>blown-glass/aluminium</i>	trasparente/alluminio anodico <i>transparent/anodic aluminium</i>	CE

NIWA

Christophe Pillet
2017



1180

pagine/pages

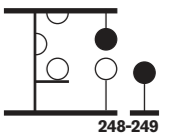
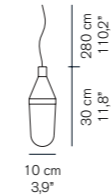

CODICE/CODE	SORGENTI/BULBS	MATERIALI/MATERIALS	COLORE/COLORS	MARCHI/MARKS
1180	 1 x max 15 W LED E27	alluminio/vetro <i>aluminium/glass</i>	grigio beige <i>beige grey</i>	CE



**LANTERNA
LANTERNINA**

Laudani & Romanelli
1998



471

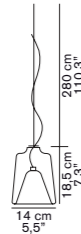

477



pagine/pages

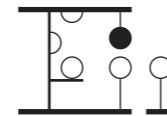

CODICE/CODE	SORGENTI/BULBS	MATERIALI/MATERIALS	COLORE/COLORS	MARCHI/MARKS
471	1 x max 40 W E14	alluminio / vetro soffiato <i>aluminium / blown glass</i>	trasparente sabbiato <i>transparent sand blasted</i>	
477	1 x max 100 W E27	alluminio / vetro soffiato <i>aluminium / blown glass</i>	trasparente sabbiato <i>transparent sand blasted</i>	



lampade esterno / outdoor lamps

- 242 AMANITA
- 244 OTTO
- 248 NIWA
- 250 LYNDON
- 256 FRESNEL
- 260 STONES

AMANITA
Mariana
Pellegrino Soto
2019



319

pagine/ pages

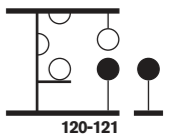
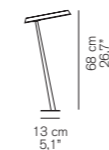

CODICE/CODE	SORGENTI/BULBES	MATERIALI/MATERIALS	COLORE/COLORS	MARCHI/MARKS
319	1 x max 6 W LED 3000° K 600 lm CRI >85 IP44	metallo /PMMA metal /PMMA	indian brown /trasparente indian brown /transparent	CE



OTTO
 Federica Farina
 2019



329

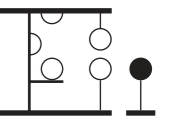
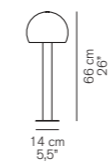

CODICE/CODE	SORGENTI/BULBES	MATERIALI/MATERIALS	COLORE/COLORS	MARCHI/MARKS
329	1 x max 6 W LED 3000° K 600 lm CRI >85	metallo metal	indian brown indian brown	CE
IP44				





NIWA
 Christophe Pillet
 2017



1182

pagine/ pages

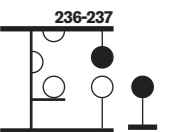
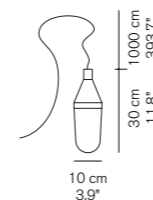

CODICE/CODE	SORGENTI/BULBS	MATERIALI/MATERIALS	COLORE/COLORS	MARCHI/MARKS
1182	 1 x max 15 W  E27 LED IP44	alluminio / vetro aluminium / glass	grigio beige beige grey	



LYNDON
Vico Magistretti
1977



350

40 cm
15,6"

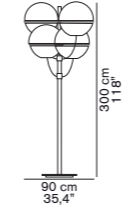

350/M

30 cm
11,8"

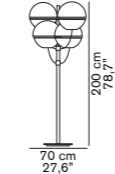

pagine/ pages

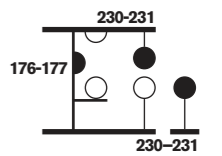

CODICE/CODE

SORGENTI/BULBS

MATERIALI/MATERIALS

COLORE/COLORS

MARCHI/MARKS

350

☀
IP23

4 x max 100 W
E27

metallo / policarbonato
metal / polycarbonate

nero / trasparente
black / transparent

CE

350/M

☀
IP23

4 x max 100 W
E27

metallo / policarbonato
metal / polycarbonate

nero / trasparente
black / transparent

CE





LYNDON
Vico Magistretti
1977



160

160/M

pagine/pages

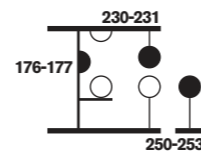
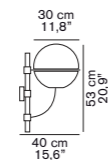
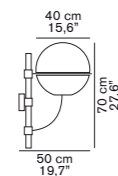

CODICE/CODE	SORGENTI/BULBS	MATERIALI/MATERIALS	COLORE/COLORS	MARCHI/MARKS
160	1 x max 100 W E27	metallo / policarbonato metal / polycarbonate	nero / trasparente black / transparent	CE
160/M	1 x max 100 W E27	metallo / policarbonato metal / polycarbonate	nero / trasparente black / transparent	CE

FRESNEL
Joe Colombo
1966



1148 - 1148/LBT

pagine/pages

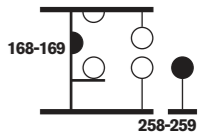
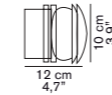

CODICE/CODE	SORGENTI/BULBS	MATERIALI/MATERIALS	COLORE/COLORS	MARCHI/MARKS
1148	1 x max 40 W E14	metallo / vetro trasparente sabbiato metal / glass sand blasted transparent	bianco / nero / grigio white / black / grey	CE UCC
1148/LBT	1 x max 4,5 W LED 220 V 3000° K 500lm CRI >85	metallo / vetro trasparente sabbiato metal / glass sand blasted transparent	bianco / nero / grigio white / black / grey	CE



FRESNEL

Joe Colombo
1966



1148/EC

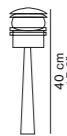

1148/EL



pagine/pages

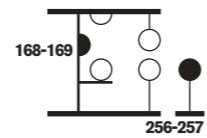

CODICE/CODE	SORGENTI/BULBS	MATERIALI/MATERIALS	COLORE/COLORS	MARCHI/MARKS
1148/EC	1 x max 40 W E14	metallo / vetro stampato metal / moulded glass	nero / trasparente sabbiato black / sand blasted transparent	CE
1148/EL	1 x max 40 W E14	metallo / vetro stampato metal / moulded glass	nero / trasparente sabbiato black / sand blasted transparent	CE



STONES

Laudani & Romanelli
2002



207

208

215

pagine/pages

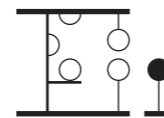
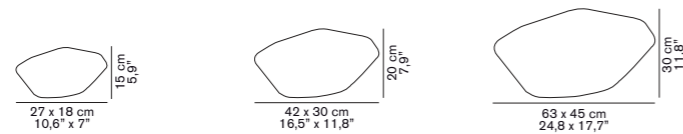

CODICE/CODE	SORGENTI/BULBS	MATERIALI/MATERIALS	COLORE/COLORS	MARCHI/MARKS
207	1 x max 8 W E27 (LED)	nylon / polietilene nylon / polyethylene	bianco white	CE
	IP65			
208	1 x max 15 W E27 (LED)	nylon / polietilene nylon / polyethylene	bianco white	CE
	IP65			
215	1 x max 15 W E27 (LED)	nylon / polietilene nylon / polyethylene	bianco white	CE
	IP65			

Legenda / Marking

CE Attesta la conformità del prodotto alle disposizioni delle direttive comunitarie / It certifies the conformity of the product to the European community low voltage directive

UL Marchio di conformità U.S.A. e Canada / U.S.A. and Canada conformity seal

CCC Marchio di conformità Cina / China conformity seal

☀ Le lampadine sono incluse / Bulbs are included

☀ Le lampadine non sono incluse / Bulbs are not included

□ Apparecchio in Classe II: apparecchio in doppio isolamento / Class II luminaire: appliance with double insulation

IP23 Apparecchio protetto contro la pioggia / Rainproof lamp

IP44 Apparecchio protetto contro gli spruzzi d'acqua / Water spray proof lamp

IP45-55-65 Apparecchio protetto contro i getti d'acqua / Water jet proof lamp

universal dimmer Lampade dotate di dimmer universale funzionanti con lampadine a LED dimmerabili e lampadine tradizionali / Lamps with universal dimmer compatible with dimmable LED bulbs and traditional bulbs

Note / Notes

I colori dei prodotti possono variare rispetto a quanto rappresentato nel catalogo e da lotto a lotto / Products colors can differ from what is shown in the catalogue and from batch to batch

Vetro soffiato a bocca Bolle d'aria, striature, lievi imperfezioni superficiali o scoloriture sono caratteristiche tipiche di tutti i vetri di qualità, soffiati a bocca e di lavorazione artigianale. Esse non sono pertanto da considerarsi come difetti di fabbricazione / Hand blown glass Bubbles, lines, slight surface defects or discolorations are characteristics of all line mouth blown and handcrafted glass. They are not to be considered as defects.

rosoni soffitto / ceiling rose

ROSONI SOFFITTO / CEILING ROSES



ALBA 468

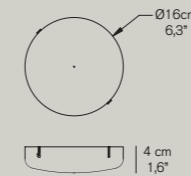

ALBA 466

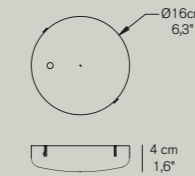

LANTERNA/INA 477, 471
SONORA 438, 411 CANOPY 421, 422
RECUERDO 484, ALBA 465
IRIDE 878, 879 (nero/black)

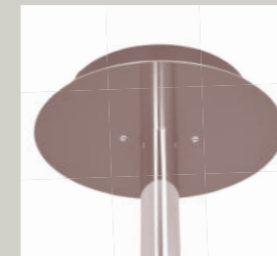
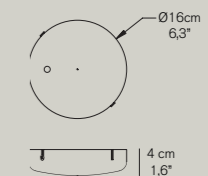

LYNDON 450 CR
LYNDON 450 OR
(oro satinato/satin gold)

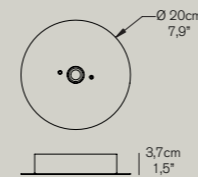

THE GLOBE 827, 828 TR
THE GLOBE 827, 828 OR
(bronzo anodico/anodic bronze)

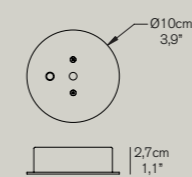

BERLIN 823

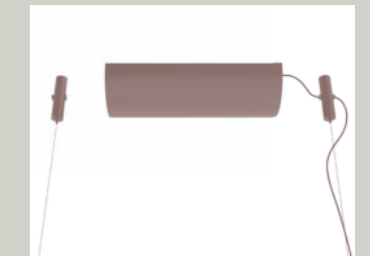
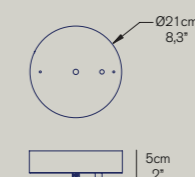

DANCING QUEEN 456

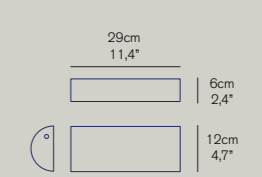

ILO 487

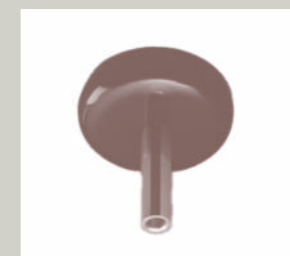
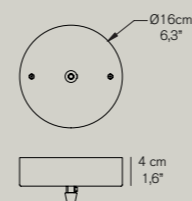

COLOMBO 885/L NE
885/L AB (bronzo anodico/anodic bronze)
885/L RO (rosso scarlet/scarlet red)

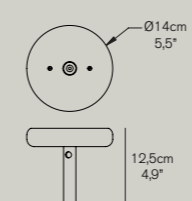

SONORA 490 NE/ORNE
NIWA 1180

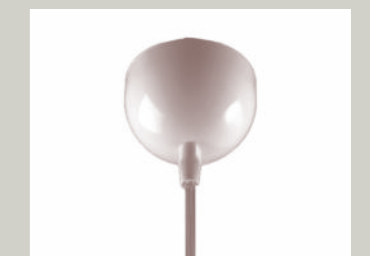
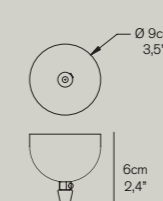

SONORA 490 BI/BC/ORBC
493 BI/BC

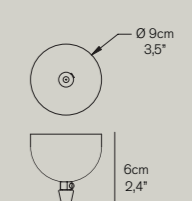



KIN 478/479 OR
KIN 478/479 AB
(bronzo anodico/anodic bronze)

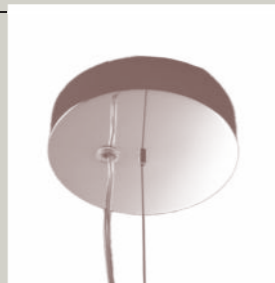
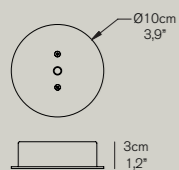

FIORE 423,433

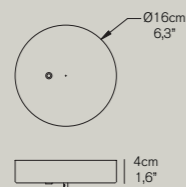

SONORA 408, 437

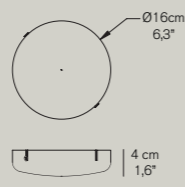

MULTIROSONE
/ MULTIPLE CEILING CAP



KIN 478/479 SR
LANTERNA/INA 477, 471 SR
ALBA 465 SR
RECUERDO 484 SR
THE GLOBE 827, 828 SR

TONDO / PLATE
bianco - nero
white - black

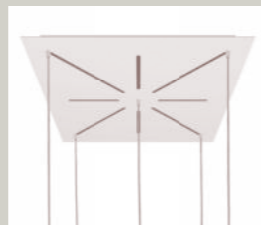
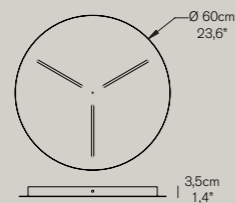

QUADRATO / SQUARE
bianco - nero
white - black

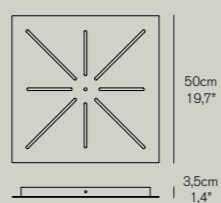

premi e riconoscimenti / awards and honors

LANTERNA

“The state of things”
(curated by J. Morrison)
Berlin, Brunswick 1999,
Köln 2000

Selezione Compasso
d’Oro ADI
Milano 2001

PERSONAL 230

Selezione Compasso
d’Oro ADI
Milano 1989

NUVOLA 196

Selezione Compasso
d’Oro ADI
Milano 2001

ATOLLO 233

Compasso d’Oro ADI
Milano 1979

“Kunstgewerbe
Museum” Zürich 1983

“Museum of Modern
Art”
New York 1979

Collezione Permanente
del Design Italiano,
Triennale di Milano

“Philadelphia Museum
of Art”
Philadelphia 1983

Museum “Die Neue
Sammlung”
München 1983

“Musuem Für Kunst
und Gewerbe”
Hamburg 1986

“Kunstmuseum”
Düsseldorf 1989

KUTA 250

“Museum Für Kunst
und Gewerbe”
Hamburg 1986

SPRING

Segnalazione XIV
Triennale Milano
1968

International Design
Award American
Institute of Interior
Designers Chicago
1970

Museum of Modern Art
New York 1970

SPIDER 3319

“Italy: the New
Domestic Landscape”
MoMA, New York 1972

“Philadelphia Museum
of Art”,
Philadelphia 1983

“Kunstmuseum”
Düsseldorf 1989

Collezione Permanente
del Design Italiano
Triennale di Milano

SUPERLUNA

German Design Award
2018

NARA 420

Selezione Compasso
d’Oro ADI
Milano 1981

NUVOLA 195

Selezione Compasso
d’Oro ADI
Milano 2001

363

Segnalazione
Compasso d’Oro,
Milano 1955

DOGALE 512

Museum “Die Neue
Sammlung”
München 1983

“Museum Fuer
Angewandte Kunst”
Köln 1990

BERLIN 720-721

Archiproducts Design
Awards 2017

SLALOM 299

Museum “Die Neue
Sammlung”
München 1983

Selezione Compasso
d’Oro ADI
Milano 1984

“Museum Fuer
Angewandte Kunst”
Köln 1990

COLOMBO 626

Museum “Die Neue
Sammlung”
München 1983*

Museum Für
Angewandte Kunst”
Köln 1990

“Kunstmuseum”
Düsseldorf 1989

POLIVINILE	Segnalazione Compasso d'Oro, Milano 1956	SNOW 401	Museum "Die Neue Sammlung" München 1983	SISTER 365	Selezione Compasso d'Oro ADI Milano 1991
ACRILICA 281	Medaglia d'Oro XIII Triennale, Milano 1964 Museum "Die Neue Sammlung", München 1983	Collezione Permanente del Design Italiano, Triennale di Milano "Kunstgewerbe Museum", Zürich 1983	Museum of Modern Art, New York 1999 "Philadelphia Museum of Art", Philadelphia 1983	OTELLO 640	"Museum Für Kunst und Gewerbe" Hamburg 1986
IDOMENEO 121	"Museum Für Kunst und Gewerbe" Hamburg 1986	LESTER 220	"Museum Für Angewandte Kunst" Köln 1990 "Design-Auswahl 1988" Stuttgart	LU-LU	"The Wolfsonian/FIU" Miami Beach 1999
LID	Prix d'excellence Marie Claire Maison Paris 1999 "The state of things" (curated by J. Morrison) Berlin, Brunswick 1999, Köln 2000	PERLA 241	Museum "Die Neue Sammlung" München 1987	TEDA 302	"Light of the future" Frankfurt 2002
SPIDER 291	Compasso d'Oro ADI Milano 1967 "Italy: the New Domestic Landscape" MoMA, New York 1972	"Philadelphia Museum of Art" Philadelphia 1983 Museum "Die Neue Sammlung" München 1983	COUPÈ 3321	International Design Award American Institute of Interior Designers Chicago 1968	"Museum of Modern Art" New York 1968 Museum "Die Neue Sammlung" München 1983
4461	Segnalazione Compasso d'Oro, Milano 1956	S154	Segnalazione Compasso d'Oro, Milano 1955	LAMPPU	Selezione Compasso d'Oro ADI Milano 2004

Graphic Design
Luca Ladiana

Fotografie / Photos
Miro Zagnoli
Adriano Brusaferrri
Gionata Xerra con Pierpaolo Mazzola
Alessandro Gaja
Studio Azzurro
Donato Di Bello
Marcello Mariana
Federico Cedrone

Stylist
Ilaria Baccocchi Studio
Studio Salaris

Coordinamento / Coordination
Franco Lettera
R + W

thanks to
Baxter
Bloc studios
CC-Tapis
Frag
Francesca Verardo
Frigerio
Gervasoni
Gorlan
GTV
Ilaria Marelli
Lema
Mani Ceramics
Molteni & C - DADA
Montecarlo Yachts
Niki Jones
Overmarine Group
Potocco
Sans Tabù
Seambè
Texturae
when Objects Work Salvatori

oluce
Milano dal 1945



O luce s.r.l.
Via Brescia, 2 20097
San Donato Milanese - Milano
T. +39 0298491435
F. +39 0298490779
www.oluce.com
info@oluce.com

Stampato presso / printed by
Grafiche Vela Web Srl
Via Copernico 8 20082 Binasco (MI)
Novembre 2023 / November 2023

